

TOOL HOLDERS

BT

POWER MILLING CHUCK 强力刀柄的工作原理

BT

**High Rigidity
高刚性**

 Before Clamping
装夹刀具前

 After Clamping
装夹刀具后

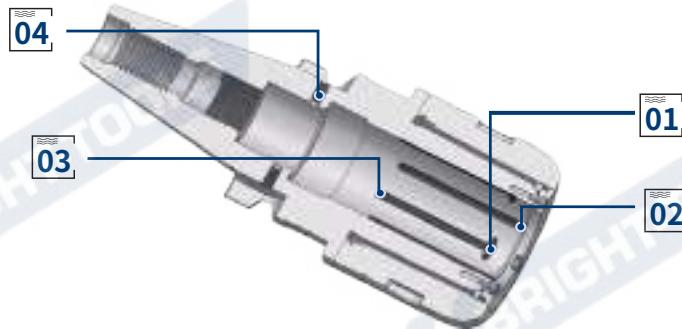
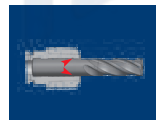
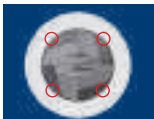
**High clamping force
高夹持力**

01 Deep groove High clamping force
深槽 增加夹紧力

02 Radial notch, prevents tool from slipping out
径向槽深, 防止刀具打滑

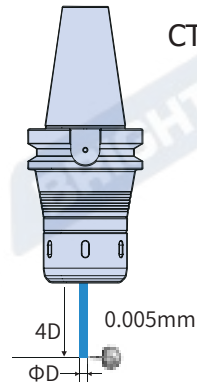
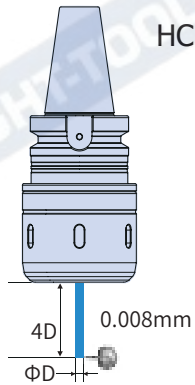
03 Prevents tool rotation
防止刀具旋转

04 a ventilation shaft
排气孔

High precision
高精度



BT

AD 中心出水



Rough machining
粗加工

- √ Aerospace machining
- √ Automotive Mould Machining
- √ Energy Equipment Heavy Cutting

- √ 航空航天加工
- √ 汽车模具加工
- √ 能源装备重切削



BT Taper Standard

BT 锥柄标准

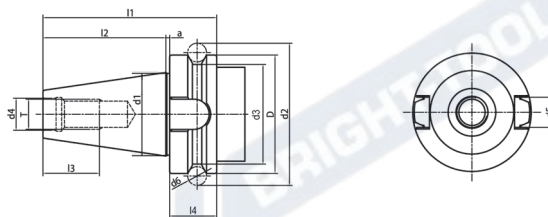
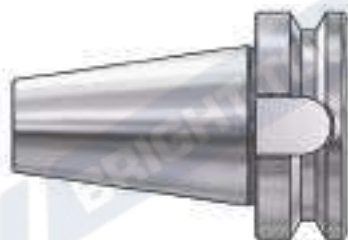

| Size | D | d1 | d2 | d3 | d4 | d5 | d6 | l1 | l2 | l3 | l4 | a | T |
|------|-----|-------|---------|----|------|------|----|-------|-------|----|----|---|----------|
| BT30 | 46 | 31.75 | 56.144 | 38 | 12.5 | 16.1 | 8 | 70.4 | 48.4 | 24 | 20 | 2 | M12*1.75 |
| BT40 | 63 | 44.45 | 75.679 | 53 | 17 | 16.1 | 10 | 92.4 | 65.4 | 30 | 25 | 2 | M16*2.0 |
| BT50 | 100 | 69.85 | 119.019 | 85 | 25 | 25.7 | 15 | 139.8 | 101.8 | 45 | 35 | 3 | M24*3.0 |

Taper standard: JIS B 6339

Material: Alloyed case hardened steel

Surface Treatment: Blackening and Bright

Taper tolerance: <AT3

Hardness: HRC 56-60

Carbon depth: 0.8±0.2mm

Surface Roughness: Ra<0.2µm

Balancing: G6.3/15000; G2.5/25000

Cooling: AD; AD/B can be made by request.

BT TOOLING SYSTEM

BT 工具系统

| | |
|--|------|
| ER Collet Chuck..... | D.06 |
| ER 弹簧夹头刀柄 | |
| ER Collet Chuck,Shrot..... | D.11 |
| ER 弹簧夹头刀柄,超短型 | |
| GER Collet Chuck | D.11 |
| GER 弹簧夹头刀柄 | |
| Power Milling Chuck | D.12 |
| 强力铣刀柄 | |
| OZ Collet C huck..... | D.15 |
| OZ 夹头刀柄 | |
| TG Collet Chuck | D.15 |
| TG 超强力刀柄 | |
| SKS Collet Chuck..... | D.16 |
| SKS 高速筒夹刀柄 | |
| Pull Back Collet Chuck | D.17 |
| DC 后拉刀柄 | |
| Precision Screw Collet Chuck..... | D.18 |
| NDC 后拉刀柄 | |
| Face Mill Holder..... | D.19 |
| 面铣刀柄 | |
| Combi Shell Mill Holder..... | D.23 |
| 混合插入式铣刀柄 | |
| End Mill Holder..... | D.24 |
| 侧固刀柄 | |
| Morse Taper Adapter..... | D.30 |
| 带扁尾莫氏刀柄 | |
| Morse Taper Adapter..... | D.31 |
| 带螺纹孔莫氏刀柄 | |
| Tool Holder Adatper Sleeve | D.33 |
| 转换刀柄 | |
| Drill Chuck Adapter..... | D.33 |
| 钻接杆 | |
| APU Drill Chuck Holder | D.33 |
| APU 钻夹头刀柄 | |
| Precision Drill Chuck Holder..... | D.34 |
| 精密钻夹头刀柄 | |
| Quick Change Tapping Chuck..... | D.36 |
| 弹性快换攻丝刀柄 | |
| Screw-in Milling Cutter Holder..... | D.33 |
| SOM 锁牙刀柄 | |
| Runout Adjustable Flange Adapter | D.35 |
| 可调节精度法兰刀柄 | |
| UM Adjustable..... | D.36 |
| UM调零刀柄 | |
| Boring Bar Blank..... | D.39 |
| 基础柄 | |
| Test Arbor..... | D.39 |
| 主轴检测棒 | |
| Alignment Tool for ATC Arm | D.40 |
| 调整机械手用组合模具 | |



BT

ER Collet Chuck with UM Nut

ER 弹簧夹头刀柄

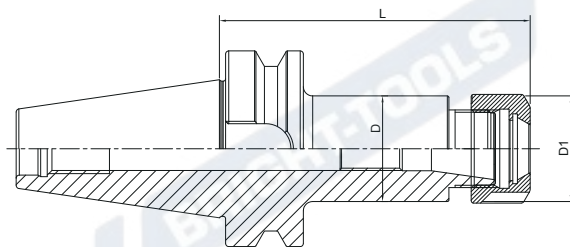
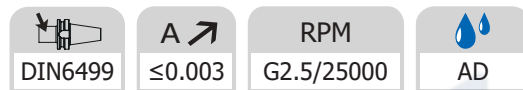

| Size | D | D1 | L | Capacity |
|-----------------|----|----|-----|----------|
| BT30-ER16UM-70 | 28 | 32 | 70 | 1-10 |
| BT30-ER20UM-70 | 34 | 35 | 70 | 1-13 |
| BT30-ER25-70 | 42 | 42 | 70 | 2-16 |
| BT30-ER32-70 | 40 | 50 | 70 | 2-20 |
| BT30-ER40-70 | 50 | 63 | 70 | 3-26 |
| BT30-ER16UM-100 | 28 | 32 | 100 | 1-10 |
| BT30-ER20UM-100 | 34 | 35 | 100 | 1-13 |
| BT30-ER25-100 | 42 | 42 | 100 | 2-16 |
| BT30-ER32-100 | 40 | 50 | 100 | 2-20 |

| | | | | |
|-----------------|----|----|-----|------|
| BT40-ER16UM-70 | 28 | 32 | 70 | 1-10 |
| BT40-ER20UM-70 | 34 | 35 | 70 | 1-13 |
| BT40-ER25-70 | 42 | 42 | 70 | 2-16 |
| BT40-ER32-70 | 50 | 50 | 70 | 2-20 |
| BT40-ER40-80 | 50 | 63 | 80 | 3-26 |
| BT40-ER16UM-100 | 28 | 32 | 100 | 1-10 |
| BT40-ER20UM-100 | 34 | 35 | 100 | 1-13 |
| BT40-ER25-100 | 42 | 42 | 100 | 2-16 |
| BT40-ER32-100 | 50 | 50 | 100 | 2-20 |
| BT40-ER40-100 | 50 | 63 | 100 | 3-26 |
| BT40-ER16UM-160 | 28 | 32 | 160 | 1-10 |
| BT40-ER20UM-160 | 34 | 35 | 160 | 1-13 |
| BT40-ER25-160 | 42 | 42 | 160 | 2-16 |
| BT40-ER32-160 | 50 | 50 | 160 | 2-20 |
| BT40-ER40-160 | 50 | 63 | 160 | 3-26 |

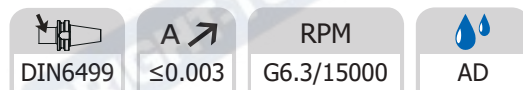

| Size | D | D1 | L | Capacity |
|-----------------|----|----|-----|----------|
| BT40-ER16UM-200 | 28 | 32 | 200 | 1-10 |
| BT40-ER20UM-200 | 34 | 35 | 200 | 1-13 |
| BT40-ER25-200 | 42 | 42 | 200 | 2-16 |
| BT40-ER32-200 | 50 | 50 | 200 | 2-20 |
| BT40-ER40-200 | 50 | 63 | 200 | 3-26 |

ER Collet Chuck with UM Nut
ER 弹簧夹头刀柄

| | | | |
|---------|------------------------------|-------------------|----|
| DIN6499 | A \nearrow ≤ 0.003 | RPM G6.3/15000 | AD |
|---------|------------------------------|-------------------|----|

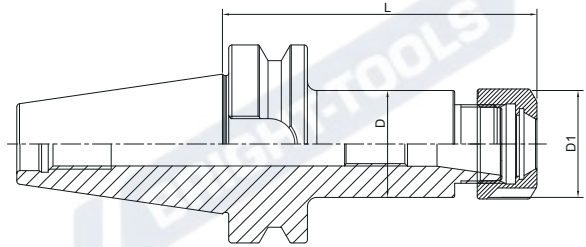

| Size | D | D1 | L | Capacity |
|-----------------|----|----|-----|----------|
| BT50-ER16UM-70 | 28 | 32 | 70 | 1-10 |
| BT50-ER20UM-70 | 34 | 35 | 70 | 1-13 |
| BT50-ER25-70 | 42 | 42 | 70 | 2-16 |
| BT50-ER32-70 | 40 | 50 | 70 | 2-20 |
| BT50-ER40-80 | 63 | 63 | 80 | 3-26 |
| BT50-ER50-100 | 64 | 78 | 100 | 6-34 |
| | | | | |
| BT50-ER16UM-100 | 28 | 32 | 100 | 1-10 |
| BT50-ER20UM-100 | 34 | 35 | 100 | 1-13 |
| BT50-ER25-100 | 42 | 42 | 100 | 2-16 |
| BT50-ER32-100 | 50 | 50 | 100 | 2-20 |
| BT50-ER40-100 | 63 | 63 | 100 | 3-26 |
| | | | | |
| BT50-ER16UM-160 | 28 | 32 | 160 | 1-10 |
| BT50-ER20UM-160 | 34 | 35 | 160 | 1-13 |
| BT50-ER25-160 | 42 | 42 | 160 | 2-16 |
| BT50-ER32-160 | 50 | 50 | 160 | 2-20 |
| BT50-ER40-160 | 63 | 63 | 160 | 3-26 |
| | | | | |
| BT50-ER16UM-200 | 28 | 32 | 200 | 1-10 |
| BT50-ER20UM-200 | 34 | 35 | 200 | 1-13 |
| BT50-ER25-200 | 42 | 42 | 200 | 2-16 |
| BT50-ER32-200 | 50 | 50 | 200 | 2-20 |
| BT50-ER40-200 | 63 | 63 | 200 | 3-26 |
| | | | | |
| BT50-ER25-250 | 42 | 42 | 250 | 2-16 |
| BT50-ER32-250 | 50 | 50 | 250 | 2-20 |
| BT50-ER40-250 | 63 | 63 | 250 | 3-26 |
| | | | | |
| BT50-ER25-300 | 42 | 42 | 300 | 2-16 |
| BT50-ER32-300 | 50 | 50 | 300 | 2-20 |
| BT50-ER40-300 | 63 | 63 | 300 | 3-26 |

AD/B Customized

AD/B 可定制

BT

ER Collet Chuck with UM Nut ER 弹簧夹头刀柄

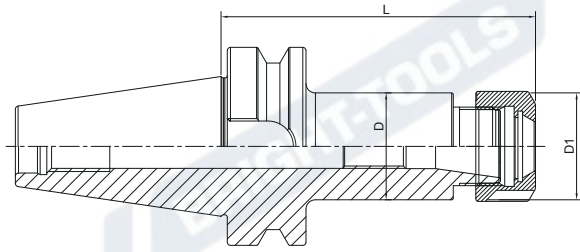
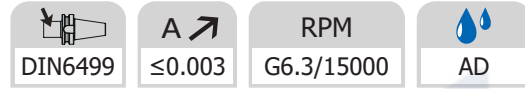

| Size | D | D1 | L | Capacity |
|---------------|----|----|-----|----------|
| BT60-ER32-100 | 50 | 50 | 100 | 2-20 |
| BT60-ER40-100 | 63 | 63 | 100 | 3-26 |
| BT60-ER50-100 | 64 | 78 | 100 | 6-34 |
| BT60-ER32-160 | 50 | 50 | 160 | 2-20 |
| BT60-ER40-160 | 63 | 63 | 160 | 3-26 |
| BT60-ER50-160 | 64 | 78 | 160 | 6-34 |

AD/B Customized

AD/B 可定制

ER Collet Chuck with Hex Nut ER 弹簧夹头刀柄

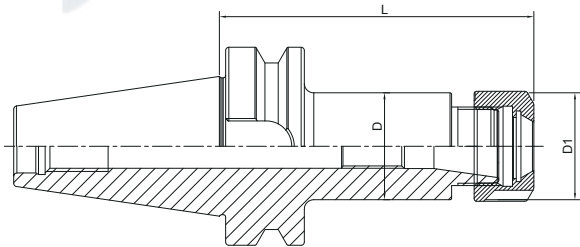
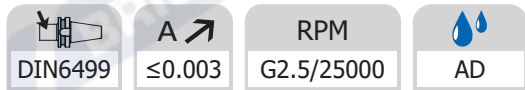

| Size | D | D1 | L | Capacity |
|---------------|----|----|-----|----------|
| BT30-ER16-70 | 28 | 28 | 70 | 1-10 |
| BT30-ER20-70 | 34 | 34 | 70 | 1-13 |
| BT30-ER16-100 | 28 | 28 | 100 | 1-10 |
| BT30-ER20-100 | 34 | 34 | 100 | 1-13 |
| BT40-ER16-70 | 28 | 28 | 70 | 1-10 |
| BT40-ER20-70 | 34 | 34 | 70 | 1-13 |
| BT40-ER16-100 | 28 | 28 | 100 | 1-10 |
| BT40-ER20-100 | 34 | 34 | 100 | 1-13 |
| BT40-ER16-160 | 28 | 28 | 160 | 1-10 |
| BT40-ER20-160 | 34 | 34 | 160 | 1-13 |

ER Collet Chuck with Hex Nut
ER 弹簧夹头刀柄

| | | | |
|---------|----------------|----------------|----|
| DIN6499 | A ≤ 0.003 | RPM G6.3/25000 | AD |
|---------|----------------|----------------|----|

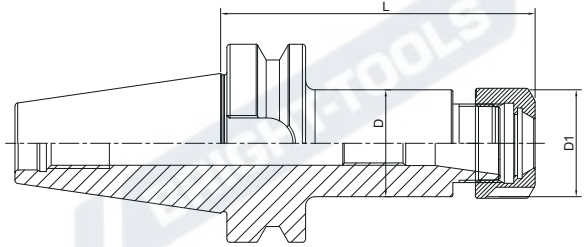

| Size | D | D1 | L | Capacity |
|----------------|----|----|-----|----------|
| BT40-ER16-200T | 28 | 28 | 200 | 1-10 |
| BT40-ER20-200 | 34 | 34 | 200 | 1-13 |
| BT50-ER16-70 | 28 | 28 | 70 | 1-10 |
| BT50-ER20-70 | 34 | 34 | 70 | 1-13 |
| BT50-ER16-100 | 28 | 28 | 100 | 1-10 |
| BT50-ER20-100 | 34 | 34 | 100 | 1-13 |
| BT50-ER16-160 | 28 | 28 | 160 | 1-10 |
| BT50-ER20-160 | 34 | 34 | 160 | 1-13 |
| BT50-ER16-200T | 28 | 28 | 200 | 1-10 |
| BT50-ER20-200 | 34 | 34 | 200 | 1-13 |

AD/B Customized
 T refers to cutter side with taper design

AD/B 可定制
 T 代表刀具端锥柄设计

ER Collet Chuck with Mini Nut ER 弹簧夹头刀柄

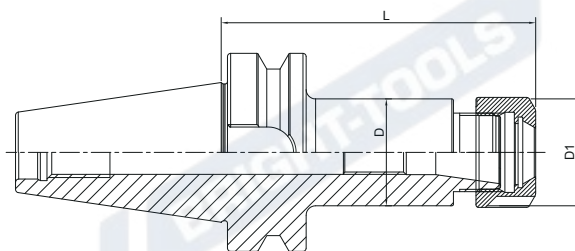
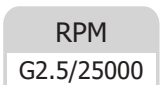
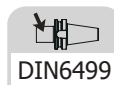

| Size | D | D1 | L | Capacity |
|-----------------|----|----|-----|----------|
| BT30-ER11M-70 | 16 | 16 | 70 | 1-7 |
| BT30-ER16M-70 | 22 | 22 | 70 | 1-10 |
| BT40-ER11M-70 | 16 | 16 | 70 | 1-7 |
| BT40-ER16M-70 | 22 | 22 | 70 | 1-10 |
| BT40-ER20M-70 | 28 | 28 | 70 | 1-13 |
| BT40-ER25M-70 | 35 | 35 | 70 | 2-16 |
| BT40-ER11M-100 | 16 | 16 | 100 | 1-7 |
| BT40-ER16M-100 | 22 | 22 | 100 | 1-10 |
| BT40-ER20M-100 | 28 | 28 | 100 | 1-13 |
| BT40-ER25M-100 | 35 | 35 | 100 | 2-16 |
| BT40-ER11M-160T | 16 | 16 | 160 | 1-7 |
| BT40-ER16M-160T | 22 | 22 | 160 | 1-10 |
| BT40-ER20M-160 | 28 | 28 | 160 | 1-13 |
| BT40-ER25M-160 | 35 | 35 | 160 | 2-16 |

RPM
G6.3/15000

| Size | D | D1 | L | Capacity |
|-----------------|----|----|-----|----------|
| BT50-ER16M-100 | 22 | 22 | 100 | 1-10 |
| BT50-ER20M-100 | 28 | 28 | 100 | 1-13 |
| BT50-ER25M-100 | 35 | 35 | 100 | 2-16 |
| BT50-ER16M-160T | 22 | 22 | 160 | 1-10 |
| BT50-ER20M-160 | 28 | 28 | 160 | 1-13 |
| BT50-ER25M-160 | 35 | 35 | 160 | 2-16 |

AD/B Customized
T refers to cutter side with taper design

AD/B 可定制
T 代表刀具端锥柄设计

ER Collet Chuck, Shrot
ER 弹簧夹头刀柄, 超短型

| | | | |
|---------|------------------------------|-------------------|----|
| DIN6499 | A \nearrow ≤ 0.003 | RPM G2.5/25000 | AD |
|---------|------------------------------|-------------------|----|

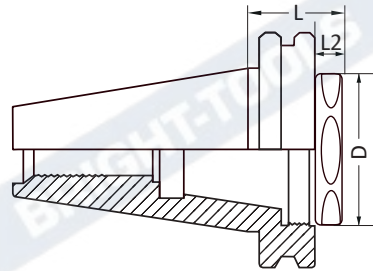

| Size | D | L | L1 |
|--------------|------|----|----|
| BT40-ER25-36 | 29.5 | 36 | 9 |
| BT40-ER32-36 | 37.5 | 36 | 9 |

ER Collet Chuck with GER Nut
ER 弹簧夹头刀柄

| | | | |
|---------|------------------------------|-------------------|----|
| DIN6499 | A \nearrow ≤ 0.003 | RPM G2.5/25000 | AD |
|---------|------------------------------|-------------------|----|

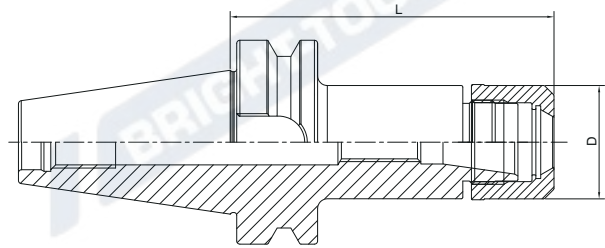

| Size | D1 | L | Capacity |
|----------------|----|-----|----------|
| BT30-GER16-70 | 30 | 70 | 1-10 |
| BT30-GER20-70 | 35 | 70 | 1-13 |
| BT30-GER25-70 | 40 | 70 | 2-16 |
| BT30-GER32-70 | 48 | 70 | 2-20 |
| | | | |
| BT40-GER16-70 | 30 | 70 | 1-10 |
| BT40-GER20-70 | 35 | 70 | 1-13 |
| BT40-GER25-70 | 40 | 70 | 2-16 |
| BT40-GER32-70 | 48 | 70 | 2-20 |
| BT40-GER16-100 | 30 | 100 | 1-10 |
| BT40-GER20-100 | 35 | 100 | 1-13 |
| BT40-GER25-100 | 40 | 100 | 2-16 |
| BT40-GER32-100 | 48 | 100 | 2-20 |
| | | | |
| BT50-GER16-100 | 30 | 100 | 1-10 |
| BT50-GER20-100 | 35 | 100 | 1-13 |
| BT50-GER25-100 | 40 | 100 | 2-16 |
| BT50-GER32-100 | 48 | 100 | 2-20 |

Power Milling Chuck 强力铣刀柄

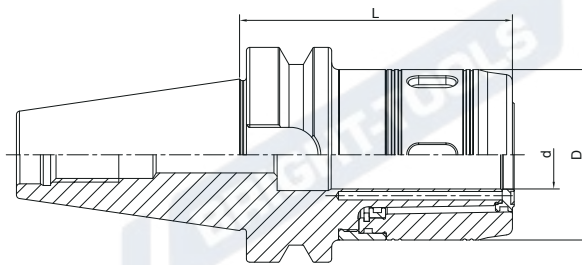

| Size | d | D | L | Capacity |
|---------------|----|----|-----|----------|
| BT30-HC20-80 | 20 | 50 | 80 | 3-16; 20 |
| BT30-HC25-90 | 25 | 59 | 90 | 3-20; 25 |
| BT30-HC32-110 | 32 | 72 | 110 | 3-25; 32 |
| BT40-HC20-90 | 20 | 50 | 90 | 3-16; 20 |
| BT40-HC25-100 | 25 | 59 | 100 | 3-20; 25 |
| BT40-HC32-90 | 32 | 72 | 90 | 3-25; 32 |
| BT40-HC32-105 | 32 | 72 | 105 | 3-25; 32 |
| BT40-HC32-165 | 32 | 72 | 165 | 3-25; 32 |
| BT40-HC42-130 | 42 | 99 | 130 | 3-32; 42 |
| BT50-HC20-105 | 20 | 50 | 105 | 3-16; 20 |
| BT50-HC25-105 | 25 | 59 | 105 | 3-20; 25 |
| BT50-HC32-110 | 32 | 72 | 110 | 3-25; 32 |
| BT50-HC42-110 | 42 | 99 | 110 | 3-32; 42 |
| BT50-HC32-165 | 32 | 72 | 165 | 3-25; 32 |
| BT50-HC32-200 | 32 | 72 | 200 | 3-25; 32 |
| BT50-HC32-250 | 32 | 72 | 250 | 3-25; 32 |
| BT50-HC32-300 | 32 | 72 | 300 | 3-25; 32 |
| BT60-HC32-130 | 32 | 72 | 130 | 3-25; 32 |
| BT60-HC42-130 | 42 | 99 | 130 | 3-32; 42 |

Power Milling Chuck
强力铣刀柄

NEW

A ↗
 ≤0.005

AD



Type 1

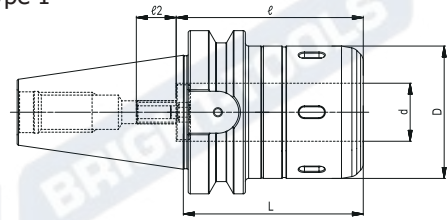

Type 2

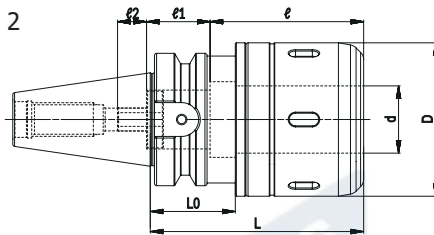

Type 3

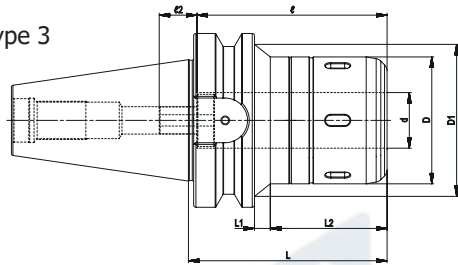

| Size | Type | d | D | D1 | L | L1 | L2 | ℓ | ℓ1 | ℓ2 | d1 | L0 | G |
|-----------------|------|----|----|----|-----|----|----|-----|----|----|----|----|-----|
| BT30-CT16SA-90 | 1 | 16 | 45 | - | 90 | - | - | 65 | - | 15 | - | - | M10 |
| BT30-CT20SA-90 | 2 | 20 | 52 | - | 90 | - | - | 80 | - | 15 | - | 40 | M12 |
| BT30-CT25SA-90 | 2 | 25 | 61 | - | 90 | - | - | 80 | - | 15 | - | 31 | M12 |
| BT40-CT16SA-90 | 1 | 16 | 45 | - | 90 | - | - | 65 | - | 15 | - | - | M10 |
| BT40-CT20SA-90 | 1 | 20 | 52 | - | 90 | - | - | 80 | - | 15 | - | - | M12 |
| BT40-CT25SA-90 | 1 | 25 | 61 | - | 90 | - | - | 80 | - | 15 | - | - | M12 |
| BT40-CT25SA-105 | 1 | 25 | 61 | - | 105 | - | - | 80 | - | 15 | - | - | M12 |
| BT40-CT32SA-90 | 2 | 32 | 73 | - | 90 | - | - | 76 | 32 | 17 | 26 | 31 | M18 |
| BT40-CT32SA-105 | 2 | 32 | 73 | - | 105 | - | - | 85 | 23 | 17 | 26 | 44 | M18 |
| BT40-CT32SA-135 | 2 | 32 | 73 | - | 135 | - | - | 120 | - | 17 | - | 69 | M18 |

BT

Power Milling Chuck 强力铣刀柄

NEW

| | |
|--------|----|
| A ↗ | AD |
| ≤0.005 | |



Type 1

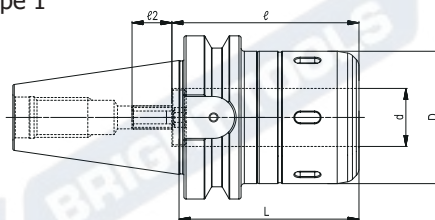

Type 2

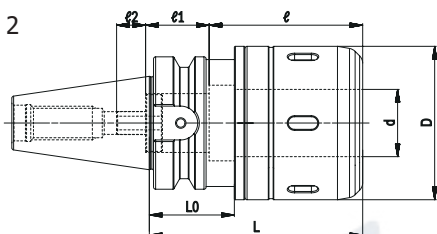

Type 3

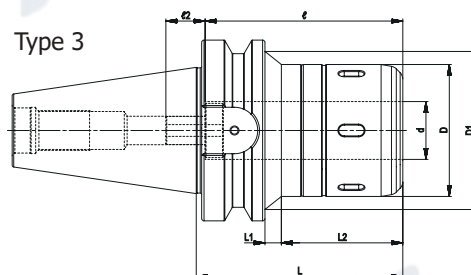

| Size | Type | d | D | D1 | L | L1 | L2 | ℓ | ℓ1 | ℓ2 | d1 | L0 | G |
|-----------------|------|----|----|-----|-----|-----|----|-----|----|----|----|----|-----|
| BT50-CT16SA-90 | 3 | 16 | 45 | 58 | 90 | 7 | 45 | 65 | - | 20 | - | - | M10 |
| BT50-CT20SA-90 | 3 | 20 | 52 | 65 | 90 | 7 | 45 | 80 | - | 15 | - | - | M12 |
| BT50-CT20SA-105 | 3 | 20 | 52 | 70 | 105 | 9 | 58 | 80 | - | 15 | - | - | M12 |
| BT50-CT20SA-135 | 3 | 20 | 52 | 73 | 135 | 39 | 58 | 80 | - | 15 | - | - | M12 |
| BT50-CT20SA-165 | 3 | 20 | 52 | 73 | 165 | 69 | 58 | 80 | - | 15 | - | - | M12 |
| BT50-CT25SA-105 | 3 | 25 | 61 | 82 | 105 | 11 | 56 | 80 | - | 15 | - | - | M12 |
| BT50-CT25SA-135 | 3 | 25 | 61 | 83 | 135 | 41 | 56 | 80 | - | 15 | - | - | M12 |
| BT50-CT25SA-165 | 3 | 25 | 61 | 86 | 165 | 71 | 56 | 80 | - | 15 | - | - | M12 |
| BT50-CT32SA-110 | 1 | 32 | 73 | - | 110 | - | - | 120 | - | 20 | - | - | M18 |
| BT50-CT32SA-135 | 3 | 32 | 73 | 88 | 135 | 41 | 56 | 120 | - | 20 | - | - | M18 |
| BT50-CT32SA-165 | 3 | 32 | 73 | 86 | 165 | 71 | 56 | 120 | - | 20 | - | - | M18 |
| BT50-CT32SA-200 | 3 | 32 | 73 | 88 | 200 | 106 | 56 | 120 | - | 20 | - | - | M18 |
| BT50-CT32SA-250 | 3 | 32 | 73 | 88 | 250 | 156 | 56 | 120 | - | 20 | - | - | M18 |
| BT50-CT32SA-300 | 3 | 32 | 73 | 88 | 300 | 206 | 56 | 120 | - | 20 | - | - | M18 |
| BT50-CT32SA-350 | 3 | 32 | 73 | 88 | 350 | 256 | 56 | 120 | - | 20 | - | - | M18 |
| BT50-CT32SA-400 | 3 | 32 | 73 | 88 | 400 | 306 | 56 | 120 | - | 20 | - | - | M18 |
| BT50-CT32SA-450 | 3 | 32 | 73 | 88 | 450 | 356 | 56 | 120 | - | 20 | - | - | M18 |
| BT50-CT42SA-105 | 1 | 42 | 88 | - | 105 | - | - | 120 | - | 20 | - | - | M18 |
| BT50-CT42SA-135 | 1 | 42 | 88 | - | 135 | - | - | 120 | - | 20 | - | - | M18 |
| BT50-CT42SA-165 | 1 | 42 | 88 | - | 165 | - | - | 120 | - | 20 | - | - | M18 |
| BT50-CT42SA-200 | 1 | 42 | 88 | - | 200 | - | - | 120 | - | 20 | - | - | M18 |
| BT50-CT42SA-250 | 1 | 42 | 88 | - | 250 | - | - | 120 | - | 20 | - | - | M18 |
| BT50-CT42SA-300 | 1 | 42 | 88 | - | 300 | - | - | 120 | - | 20 | - | - | M18 |
| BT60-CT32SA-135 | 3 | 32 | 73 | 88 | 135 | 31 | 56 | 120 | - | 20 | - | - | M18 |
| BT60-CT42SA-135 | 3 | 42 | 88 | 110 | 135 | 31 | 56 | 120 | - | 20 | - | - | M18 |

OZ Collet Chuck
OZ 夹头刀柄



| | | | |
|---------|----------------|-------------------|----|
| DIN6391 | A ≤ 0.005 | RPM G6.3/15000 | AD |
|---------|----------------|-------------------|----|

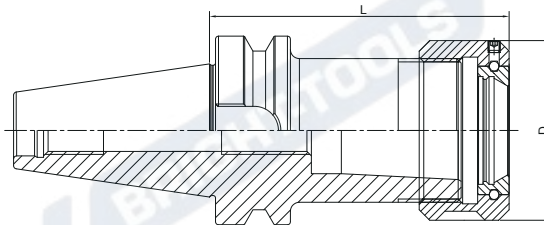

| Size | D | L | Capacity |
|--------------|----|----|----------|
| BT30-OZ16-70 | 43 | 70 | 3-16 |
| BT30-OZ25-80 | 60 | 80 | 3-25 |
| BT40-OZ16-70 | 43 | 70 | 3-16 |
| BT40-OZ25-70 | 60 | 70 | 3-25 |
| BT40-OZ32-80 | 72 | 80 | 6-32 |
| BT50-OZ25-85 | 60 | 85 | 3-25 |
| BT50-OZ32-90 | 72 | 90 | 6-32 |

TG Collet Chuck
TG 超强力刀柄



| | | |
|----------------|-------------------|----|
| A ≤ 0.005 | RPM G2.5/25000 | AD |
|----------------|-------------------|----|

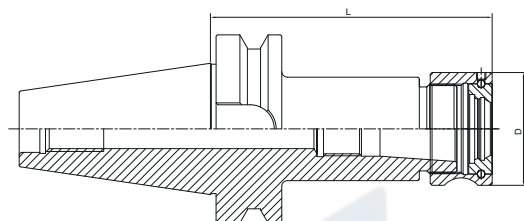

| Size | D | L | Collet | Capacity |
|----------------|----|-----|--------|----------|
| BT40-TG75-70 | 50 | 70 | TG 75 | 2-20 |
| BT40-TG100-80 | 60 | 80 | TG 100 | 3-25 |
| BT40-TG100-100 | 60 | 100 | TG 100 | 3-25 |
| BT40-TG100-150 | 60 | 150 | TG 100 | 3-25 |
| BT50-TG100-90 | 60 | 90 | TG 100 | 3-25 |
| BT50-TG100-150 | 60 | 150 | TG 100 | 3-25 |

BT

High Speed SKS Collet Chuck

SKS 高速筒夹刀柄

| | | |
|---------------|-------------------|---|
| A ↗ ≤0.003 | RPM G2.5/25000 |  AD |
|---------------|-------------------|---|

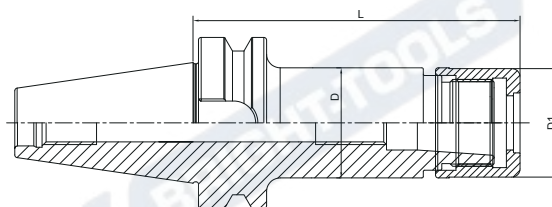

| Size | D | D1 | L | Capacity | M |
|----------------|------|------|-----|----------|---------|
| BT30-SKS10-60 | 27.5 | 27.1 | 60 | 2-10 | M21.5*1 |
| BT30-SKS16-60 | 40.6 | 40 | 60 | 3-16 | M32*1.5 |
| BT30-SKS10-90 | 27.5 | 27.1 | 90 | 2-10 | M21.5*1 |
| BT30-SKS16-90 | 40.6 | 40 | 90 | 3-16 | M32*1.5 |
| BT40-SKS10-60 | 27.5 | 27.1 | 60 | 2-10 | M21.5*1 |
| BT40-SKS16-70 | 40.6 | 40 | 70 | 3-16 | M32*1.5 |
| BT40-SKS10-90 | 27.5 | 27.1 | 90 | 2-10 | M21.5*1 |
| BT40-SKS16-90 | 40.6 | 40 | 90 | 3-16 | M32*1.5 |
| BT40-SKS20-90 | 48.5 | 48 | 90 | 2-20 | M40*1 |
| BT40-SKS25-90 | 55.6 | 55 | 90 | 6-25 | M45*1.5 |
| BT40-SKS10-120 | 27.5 | 27.1 | 120 | 2-10 | M21.5*1 |
| BT40-SKS16-120 | 40.6 | 40 | 120 | 3-16 | M32*1.5 |
| BT40-SKS20-120 | 48.5 | 48 | 120 | 2-20 | M40*1 |
| BT40-SKS25-120 | 55.6 | 55 | 120 | 6-25 | M45*1.5 |
| BT50-SK10-100 | 27.5 | 27.1 | 100 | 2-10 | M21.5*1 |
| BT50-SK16-100 | 40.6 | 40 | 100 | 3-16 | M32*1.5 |
| BT50-SKS10-120 | 27.5 | 27.1 | 120 | 2-10 | M21.5*1 |
| BT50-SKS16-120 | 40.6 | 40 | 120 | 3-16 | M32*1.5 |
| BT50-SKS10-165 | 27.5 | 27.1 | 165 | 2-10 | M21.5*1 |
| BT50-SKS16-165 | 40.6 | 40 | 165 | 3-16 | M32*1.5 |

Pull Back Collet Chuck
DC 后拉刀柄



| | | |
|----------------------|--------------------------|--|
| A ↗ ≤0.003 | RPM G2.5/25000 |  AD |
|----------------------|--------------------------|--|

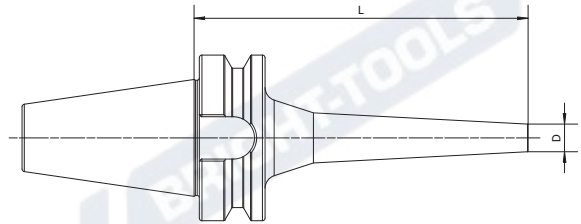

| Size | L | D | Capacity |
|---------------|-----|----|----------|
| BT30-DC06-60 | 60 | 14 | 1-6 |
| BT30-DC06-90 | 90 | 14 | 1-6 |
| BT30-DC06-120 | 120 | 14 | 1-6 |
| BT30-DC08-60 | 60 | 22 | 1-10 |
| BT30-DC08-90 | 90 | 22 | 1-10 |
| BT30-DC08-120 | 120 | 22 | 1-10 |
| BT30-DC12-80 | 80 | 34 | 1-12 |
| | | | |
| BT40-DC06-60 | 60 | 14 | 1-6 |
| BT40-DC06-90 | 90 | 14 | 1-6 |
| BT40-DC06-120 | 120 | 14 | 1-6 |
| BT40-DC06-150 | 150 | 14 | 1-6 |
| BT40-DC08-60 | 60 | 22 | 1-10 |
| BT40-DC08-90 | 90 | 22 | 1-10 |
| BT40-DC08-120 | 120 | 22 | 1-10 |
| BT40-DC08-150 | 150 | 22 | 1-10 |
| BT40-DC08-200 | 200 | 22 | 1-10 |
| BT40-DC12-90 | 90 | 34 | 1-12 |
| BT40-DC12-120 | 120 | 34 | 1-12 |
| BT40-DC12-150 | 150 | 34 | 1-12 |
| BT40-DC12-200 | 200 | 34 | 1-12 |
| | | | |
| BT50-DC06-120 | 120 | 14 | 1-6 |
| BT50-DC06-150 | 150 | 14 | 1-6 |
| BT50-DC08-120 | 120 | 22 | 1-10 |
| BT50-DC08-150 | 150 | 22 | 1-10 |
| BT50-DC08-200 | 200 | 22 | 1-10 |
| BT50-DC12-120 | 120 | 34 | 1-12 |
| BT50-DC12-150 | 150 | 34 | 1-12 |
| BT50-DC12-200 | 200 | 34 | 1-12 |

BT

Precision Screw Collet Chuck NDC 后拉刀柄

| | | |
|---------------|-------------------|---|
| A ↗ ≤0.003 | RPM G2.5/25000 |  AD |
|---------------|-------------------|---|

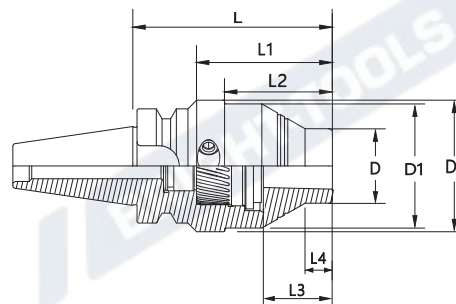

| Size | D | D1 | D2 | L | L1 | L2 | L3 | L4 | Capacity |
|----------------|----|----|----|-----|-----|----|----|----|----------|
| BT30-NDC14-80 | 30 | 50 | 53 | 80 | 56 | 43 | 26 | 11 | 4-14 |
| BT30-NDC14-130 | 24 | 30 | 53 | 130 | 105 | 78 | 60 | - | 4-14 |
| BT30-NDC20-80 | 40 | 53 | - | 80 | 56 | 28 | 19 | - | 4-20 |
| BT40-NDC20-70 | 40 | 63 | - | 70 | 38 | 18 | - | - | 4-20 |
| BT40-NDC20-120 | 40 | 63 | - | 120 | 89 | 68 | - | - | 4-20 |
| BT40-NDC14-70 | 30 | 50 | - | 70 | 43 | 28 | 11 | - | 4-14 |
| BT40-NDC14-120 | 24 | 30 | 53 | 120 | 93 | 78 | 61 | - | 4-14 |
| BT40-NDC32-110 | 53 | 63 | - | 110 | 14 | - | - | - | 12-32 |
| BT50-NDC20-130 | 34 | 55 | 70 | 130 | 93 | 81 | 73 | 24 | 4-20 |
| BT50-NDC32-145 | 60 | 70 | - | 145 | 108 | 14 | - | - | 12-32 |

Face Mill Holder Inch
英制面铣刀柄

| | | |
|---------------|-------------------|----|
| A ↗ ≤0.005 | RPM G6.3/15000 | AD |
|---------------|-------------------|----|

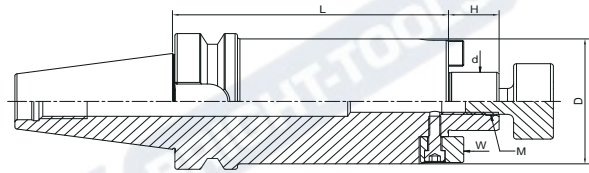

| Size | d | L | D | H | M |
|--------------------|--------|-----|--------|-------|--------|
| BT40-FMA3/4"-40 | 3/4" | 40 | 42.926 | 17.45 | 3/8-24 |
| BT40-FMA1"-40 | 1" | 40 | 55.626 | 17.45 | 1/2-20 |
| BT40-FMA1-1/4"-50 | 1-1/4" | 50 | 69.85 | 17.45 | 5/8-18 |
| BT40-FMA1-1/2"-50 | 1-1/2" | 50 | 78 | 23.83 | 3/4-16 |
| BT40-FMA3/4"-100 | 3/4" | 100 | 42.926 | 17.45 | 3/8-24 |
| BT40-FMA1"-100 | 1" | 100 | 55.626 | 17.45 | 1/2-20 |
| BT40-FMA1-1/4"-100 | 1-1/4" | 100 | 69.85 | 17.45 | 5/8-18 |
| BT40-FMA1-1/2"-100 | 1-1/2" | 100 | 78 | 23.83 | 3/4-16 |
| BT40-FMA3/4"-150 | 3/4" | 150 | 42.926 | 17.45 | 3/8-24 |
| BT40-FMA1"-150 | 1" | 150 | 55.626 | 17.45 | 1/2-20 |
| BT40-FMA1-1/4"-150 | 1-1/4" | 150 | 69.85 | 17.45 | 5/8-18 |
| BT40-FMA1-1/2"-150 | 1-1/2" | 150 | 78 | 23.83 | 3/4-16 |
| BT50-FMA3/4"-40 | 3/4" | 40 | 42.926 | 17.45 | 3/8-24 |
| BT50-FMA1"-40 | 1" | 40 | 55.626 | 17.45 | 1/2-20 |
| BT50-FMA1-1/4"-50 | 1-1/4" | 50 | 69.85 | 17.45 | 5/8-18 |
| BT50-FMA1-1/2"-50 | 1-1/2" | 50 | 78 | 23.83 | 3/4-16 |
| BT50-FMA3/4"-100 | 3/4" | 100 | 42.926 | 17.45 | 3/8-24 |
| BT50-FMA1"-100 | 1" | 100 | 55.626 | 17.45 | 1/2-20 |
| BT50-FMA1-1/4"-100 | 1-1/4" | 100 | 69.85 | 17.45 | 5/8-18 |
| BT50-FMA1-1/2"-100 | 1-1/2" | 100 | 78 | 23.83 | 3/4-16 |
| BT50-FMA3/4"-150 | 3/4" | 150 | 42.926 | 17.45 | 3/8-24 |
| BT50-FMA1"-150 | 1" | 150 | 55.626 | 17.45 | 1/2-20 |
| BT50-FMA1-1/4"-150 | 1-1/4" | 150 | 69.85 | 17.45 | 5/8-18 |
| BT50-FMA1-1/2"-150 | 1-1/2" | 150 | 78 | 23.83 | 3/4-16 |

BT

Face Mill Holder 面铣刀柄

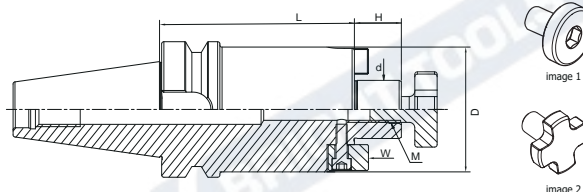
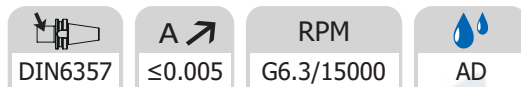

| Size | d | L | D | H | M |
|----------------|----|-----|----|----|-----|
| BT30-FMB16-40 | 16 | 40 | 38 | 17 | M8 |
| BT30-FMB22-40 | 22 | 40 | 48 | 19 | M10 |
| BT30-FMB27-40 | 27 | 40 | 58 | 21 | M12 |
| BT30-FMB32-50 | 32 | 50 | 78 | 24 | M16 |
| BT40-FMB16-40 | 16 | 40 | 38 | 17 | M8 |
| BT40-FMB22-40 | 22 | 40 | 48 | 19 | M10 |
| BT40-FMB27-40 | 27 | 40 | 58 | 21 | M12 |
| BT40-FMB32-50 | 32 | 50 | 78 | 24 | M16 |
| BT40-FMB22-60 | 22 | 60 | 48 | 19 | M10 |
| BT40-FMB27-60 | 27 | 60 | 58 | 21 | M12 |
| BT40-FMB32-60 | 32 | 60 | 78 | 24 | M16 |
| BT40-FMB16-100 | 16 | 100 | 38 | 17 | M8 |
| BT40-FMB22-100 | 22 | 100 | 48 | 19 | M10 |
| BT40-FMB27-100 | 27 | 100 | 58 | 21 | M12 |
| BT40-FMB32-100 | 32 | 100 | 78 | 24 | M16 |
| BT40-FMB16-160 | 16 | 160 | 38 | 17 | M8 |
| BT40-FMB22-160 | 22 | 160 | 48 | 19 | M10 |
| BT40-FMB27-160 | 27 | 160 | 58 | 21 | M12 |
| BT40-FMB32-160 | 32 | 160 | 78 | 24 | M16 |
| BT40-FMB40-160 | 40 | 160 | 88 | 27 | M20 |
| BT40-FMB22-200 | 22 | 200 | 48 | 19 | M10 |
| BT40-FMB27-200 | 27 | 200 | 58 | 21 | M12 |
| BT40-FMB32-200 | 32 | 200 | 78 | 24 | M16 |
| BT40-FMB22-250 | 22 | 250 | 48 | 19 | M10 |
| BT40-FMB22-300 | 22 | 300 | 48 | 19 | M10 |

Face mill holder is with retaining screw (image 2) except China, it is with universal screw (image 1) in China.
中国市场面铣刀柄标配圆头螺钉 (图 1), 其他国家标配十字花螺钉 (图 2).

AD/B Customized
AD/B 可定制

Face Mill Holder
面铣刀柄

| | | | |
|---------|------------------------------|-------------------|----|
| DIN6357 | A \nearrow ≤ 0.005 | RPM G6.3/15000 | AD |
|---------|------------------------------|-------------------|----|

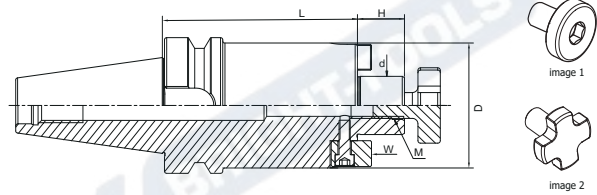

| Size | d | L | D | H | M |
|----------------|----|-----|----|----|-----|
| BT50-FMB16-40 | 16 | 40 | 38 | 17 | M8 |
| BT50-FMB22-40 | 22 | 40 | 48 | 19 | M10 |
| BT50-FMB27-40 | 27 | 40 | 58 | 21 | M12 |
| BT50-FMB32-50 | 32 | 50 | 78 | 24 | M16 |
| BT50-FMB22-60 | 22 | 60 | 48 | 19 | M10 |
| BT50-FMB27-60 | 27 | 60 | 58 | 21 | M12 |
| BT50-FMB32-60 | 32 | 60 | 78 | 24 | M16 |
| BT50-FMB16-100 | 16 | 100 | 38 | 17 | M8 |
| BT50-FMB22-100 | 22 | 100 | 48 | 19 | M10 |
| BT50-FMB27-100 | 27 | 100 | 58 | 21 | M12 |
| BT50-FMB32-100 | 32 | 100 | 78 | 24 | M16 |
| BT50-FMB22-160 | 22 | 160 | 48 | 19 | M10 |
| BT50-FMB27-160 | 27 | 160 | 58 | 21 | M12 |
| BT50-FMB32-160 | 32 | 160 | 78 | 24 | M16 |
| BT50-FMB22-200 | 22 | 200 | 48 | 19 | M10 |
| BT50-FMB27-200 | 27 | 200 | 58 | 21 | M12 |
| BT50-FMB32-200 | 32 | 200 | 78 | 24 | M16 |
| BT50-FMB22-250 | 22 | 250 | 48 | 19 | M10 |
| BT50-FMB27-250 | 27 | 250 | 58 | 21 | M12 |
| BT50-FMB32-250 | 32 | 250 | 78 | 24 | M16 |
| BT50-FMB22-300 | 22 | 300 | 48 | 19 | M10 |
| BT50-FMB27-300 | 27 | 300 | 58 | 21 | M12 |
| BT50-FMB32-300 | 32 | 300 | 78 | 24 | M16 |
| BT50-FMB22-100 | 22 | 100 | 60 | 19 | M10 |
| BT50-FMB22-150 | 22 | 150 | 60 | 19 | M10 |
| BT50-FMB22-200 | 22 | 200 | 60 | 19 | M10 |
| BT50-FMB22-250 | 22 | 250 | 60 | 19 | M10 |
| BT50-FMB22-300 | 22 | 300 | 60 | 19 | M10 |
| BT60-FMB22-100 | 22 | 100 | 48 | 19 | M10 |
| BT60-FMB27-100 | 27 | 100 | 58 | 21 | M12 |
| BT60-FMB32-100 | 32 | 100 | 78 | 24 | M16 |
| BT60-FMB22-160 | 22 | 160 | 48 | 19 | M10 |

BT

Face Mill Holder 面铣刀柄

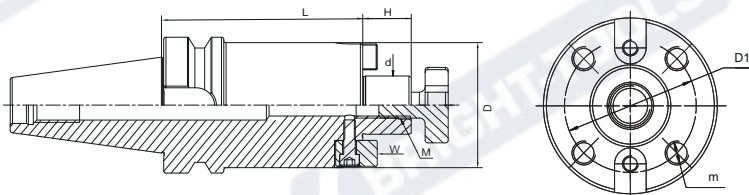
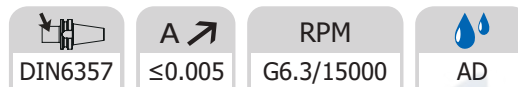

| Size | d | L | D | D1 | H | M | m |
|----------------|----|-----|-----|-------|----|-----|-----|
| BT40-FMB40-50 | 40 | 50 | 88 | 66.7 | 27 | M20 | M12 |
| BT40-FMB40-60 | 40 | 60 | 88 | 66.7 | 27 | M20 | M12 |
| BT40-FMB40-100 | 40 | 100 | 88 | 66.7 | 27 | M20 | M12 |
| BT40-FMB40-200 | 40 | 200 | 88 | 66.7 | 27 | M20 | M12 |
| BT50-FMB40-50 | 40 | 50 | 88 | 66.7 | 27 | M20 | M12 |
| BT50-FMB40-60 | 40 | 60 | 88 | 66.7 | 27 | M20 | M12 |
| BT50-FMB60-75 | 60 | 75 | 129 | 101.6 | 25 | M30 | M16 |
| BT50-FMB40-100 | 40 | 100 | 88 | 66.7 | 27 | M20 | M12 |
| BT50-FMB40-160 | 40 | 160 | 88 | 66.7 | 27 | M20 | M12 |
| BT50-FMB40-200 | 40 | 200 | 88 | 66.7 | 27 | M20 | M12 |
| BT50-FMB40-250 | 40 | 250 | 88 | 66.7 | 27 | M20 | M12 |
| BT50-FMB40-300 | 40 | 300 | 88 | 66.7 | 27 | M20 | M12 |
| BT60-FMB40-100 | 40 | 100 | 88 | 66.7 | 27 | M20 | M12 |
| BT60-FMB60-75 | 60 | 75 | 129 | 101.6 | 25 | M30 | M16 |

FMB40 tool holder is with one retaining screw (image 2) . but it is with one universal screw (image 1) in China.

FMB40 刀柄中国市场面铣刀柄标配圆头螺钉 (图 1)，其他国家标配十字花螺钉 (图 2)。

FMB60 tool holder with 4 cap screws only.

FMB60 刀柄标配 4 个内六角螺钉。

AD/B Customized

AD/B 可定制

Combi Shell Mill Holder
混合插入式铣刀柄



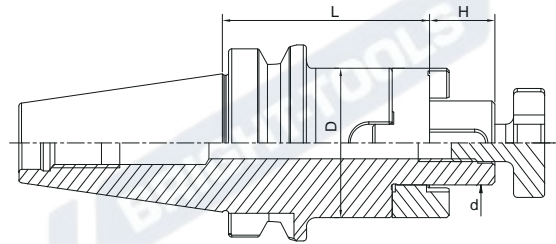

| | | | |
|---------|---------------------------|-------------------|----|
| DIN6358 | A \nearrow ≤ 0.005 | RPM G6.3/15000 | AD |
|---------|---------------------------|-------------------|----|



| Size | d | D | H | L |
|-----------------|----|----|----|-----|
| BT40-SEMC16-55 | 16 | 32 | 17 | 55 |
| BT40-SEMC22-55 | 22 | 40 | 19 | 55 |
| BT40-SEMC27-55 | 27 | 48 | 21 | 55 |
| BT40-SEMC32-60 | 32 | 58 | 24 | 60 |
| BT40-SEMC40-60 | 40 | 70 | 27 | 60 |
| BT40-SEMC16-100 | 16 | 32 | 17 | 100 |
| BT40-SEMC22-100 | 22 | 40 | 19 | 100 |
| BT40-SEMC27-100 | 27 | 48 | 21 | 100 |
| BT40-SEMC32-100 | 32 | 58 | 24 | 100 |
| BT40-SEMC40-100 | 40 | 70 | 27 | 100 |
| BT40-SEMC16-160 | 16 | 32 | 17 | 160 |
| BT40-SEMC22-160 | 22 | 40 | 19 | 160 |
| BT40-SEMC27-160 | 27 | 48 | 21 | 160 |
| BT40-SEMC32-160 | 32 | 58 | 24 | 160 |
| BT40-SEMC40-160 | 40 | 70 | 27 | 160 |
| BT50-SEMC16-70 | 16 | 32 | 17 | 70 |
| BT50-SEMC22-70 | 22 | 40 | 19 | 70 |
| BT50-SEMC27-70 | 27 | 48 | 21 | 70 |
| BT50-SEMC32-70 | 32 | 58 | 24 | 70 |
| BT50-SEMC40-70 | 40 | 70 | 27 | 70 |
| BT50-SEMC16-100 | 16 | 32 | 17 | 100 |
| BT50-SEMC22-100 | 22 | 40 | 19 | 100 |
| BT50-SEMC27-100 | 27 | 48 | 21 | 100 |
| BT50-SEMC32-100 | 32 | 58 | 24 | 100 |
| BT50-SEMC40-100 | 40 | 70 | 27 | 100 |
| BT50-SEMC16-160 | 16 | 32 | 17 | 160 |
| BT50-SEMC22-160 | 22 | 40 | 19 | 160 |
| BT50-SEMC27-160 | 27 | 48 | 21 | 160 |
| BT50-SEMC32-160 | 32 | 58 | 24 | 160 |
| BT50-SEMC40-160 | 40 | 70 | 27 | 160 |

BT

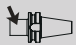
End Mill Holder Weldon
侧固刀柄

| | | | |
|--|---|--|---|
|  DIN6359/1835B |  A \nearrow ≤ 0.005 |  RPM G6.3/15000 |  AD |
|--|---|--|---|

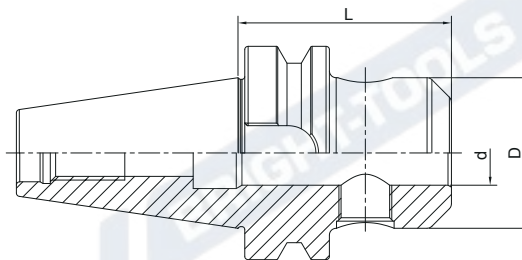

| Size | d | D | L | M | Screw Quantity |
|----------------|----|----|-----|-------|----------------|
| BT30-SLA06-50 | 6 | 25 | 50 | M6 | 1 |
| BT30-SLA08-50 | 8 | 28 | 50 | M8 | 1 |
| BT30-SLA10-50 | 10 | 35 | 50 | M10 | 1 |
| BT30-SLA12-50 | 12 | 42 | 50 | M12 | 1 |
| BT30-SLA14-50 | 14 | 44 | 50 | M12 | 1 |
| BT30-SLA16-63 | 16 | 48 | 63 | M14 | 1 |
| BT30-SLA18-63 | 18 | 50 | 63 | M14 | 1 |
| BT30-SLA20-63 | 20 | 52 | 63 | M16 | 1 |
| BT30-SLA25-90 | 25 | 65 | 90 | M18*2 | 2 |
| BT40-SLA06-50 | 6 | 25 | 50 | M6 | 1 |
| BT40-SLA08-50 | 8 | 28 | 50 | M8 | 1 |
| BT40-SLA10-63 | 10 | 35 | 63 | M10 | 1 |
| BT40-SLA12-63 | 12 | 42 | 63 | M12 | 1 |
| BT40-SLA14-63 | 14 | 44 | 63 | M12 | 1 |
| BT40-SLA16-63 | 16 | 48 | 63 | M14 | 1 |
| BT40-SLA18-63 | 18 | 50 | 63 | M14 | 1 |
| BT40-SLA20-63 | 20 | 52 | 63 | M16 | 1 |
| BT40-SLA25-90 | 25 | 65 | 90 | M18*2 | 2 |
| BT40-SLA32-100 | 32 | 72 | 100 | M20*2 | 2 |
| BT40-SLA40-120 | 40 | 80 | 120 | M20*2 | 2 |
| BT40-SLA06-100 | 6 | 25 | 100 | M6 | 1 |
| BT40-SLA08-100 | 8 | 28 | 100 | M8 | 1 |
| BT40-SLA10-100 | 10 | 35 | 100 | M10 | 1 |
| BT40-SLA12-100 | 12 | 42 | 100 | M12 | 1 |
| BT40-SLA14-100 | 14 | 44 | 100 | M12 | 1 |
| BT40-SLA16-100 | 16 | 48 | 100 | M14 | 1 |
| BT40-SLA18-100 | 18 | 50 | 100 | M14 | 1 |
| BT40-SLA20-100 | 20 | 52 | 100 | M16 | 1 |

AD/B Customized

AD/B 可定制

End Mill Holder Weldon
侧固刀柄



| | | | |
|---------------|---------------|-------------------|----|
| DIN6359/1835B | A ↗ ≤0.005 | RPM G6.3/15000 | AD |
|---------------|---------------|-------------------|----|

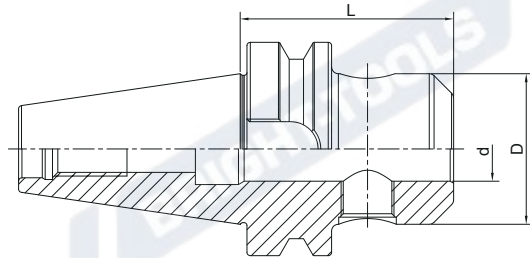

| Size | d | D | L | M | Screw Quantity |
|----------------|----|----|-----|-------|----------------|
| BT40-SLA06-160 | 6 | 25 | 160 | M6 | 1 |
| BT40-SLA08-160 | 8 | 28 | 160 | M8 | 1 |
| BT40-SLA10-160 | 10 | 35 | 160 | M10 | 1 |
| BT40-SLA12-160 | 12 | 42 | 160 | M12 | 1 |
| BT40-SLA14-160 | 14 | 44 | 160 | M12 | 1 |
| BT40-SLA16-160 | 16 | 48 | 160 | M14 | 1 |
| BT40-SLA18-160 | 18 | 50 | 160 | M14 | 1 |
| BT40-SLA20-160 | 20 | 52 | 160 | M16 | 1 |
| BT40-SLA25-160 | 25 | 65 | 160 | M18*2 | 2 |
| BT40-SLA32-160 | 32 | 72 | 160 | M20*2 | 2 |
| BT40-SLA40-160 | 40 | 80 | 160 | M20*2 | 2 |
| BT50-SLA06-63 | 6 | 25 | 63 | M6 | 1 |
| BT50-SLA08-63 | 8 | 28 | 63 | M8 | 1 |
| BT50-SLA10-63 | 10 | 35 | 63 | M10 | 1 |
| BT50-SLA12-80 | 12 | 42 | 80 | M12 | 1 |
| BT50-SLA14-80 | 14 | 44 | 80 | M12 | 1 |
| BT50-SLA16-80 | 16 | 48 | 80 | M14 | 1 |
| BT50-SLA18-80 | 18 | 50 | 80 | M14 | 1 |
| BT50-SLA20-80 | 20 | 52 | 80 | M16 | 1 |
| BT50-SLA25-100 | 25 | 65 | 100 | M18*2 | 2 |
| BT50-SLA32-105 | 32 | 72 | 105 | M20*2 | 2 |
| BT50-SLA40-110 | 40 | 80 | 110 | M20*2 | 2 |
| BT50-SLA50-125 | 50 | 98 | 125 | M24*2 | 2 |

AD/B Customized

AD/B 可定制

BT

End Mill Holder Weldon 侧固刀柄



| | | | |
|--|--|-------------------|---|
|  DIN6359/1835B |  A ≤0.005 | RPM G6.3/15000 |  AD |
|--|--|-------------------|---|

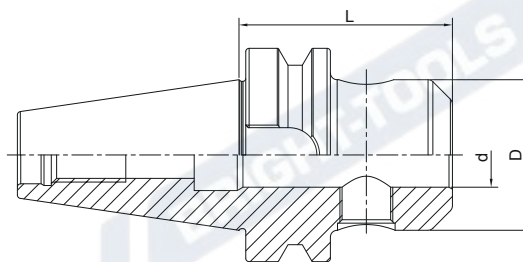

| Size | d | D | L | M | Screw Quantity |
|----------------|----|----|-----|-------|----------------|
| BT50-SLA06-160 | 6 | 25 | 160 | M6 | 1 |
| BT50-SLA08-160 | 8 | 28 | 160 | M8 | 1 |
| BT50-SLA10-160 | 10 | 35 | 160 | M10 | 1 |
| BT50-SLA12-160 | 12 | 42 | 160 | M12 | 1 |
| BT50-SLA14-160 | 14 | 44 | 160 | M12 | 1 |
| BT50-SLA16-160 | 16 | 48 | 160 | M14 | 1 |
| BT50-SLA18-160 | 18 | 50 | 160 | M14 | 1 |
| BT50-SLA20-160 | 20 | 52 | 160 | M16 | 1 |
| BT50-SLA25-160 | 25 | 65 | 160 | M18*2 | 2 |
| BT50-SLA32-160 | 32 | 72 | 160 | M20*2 | 2 |
| BT50-SLA40-160 | 40 | 80 | 160 | M20*2 | 2 |
| BT60-SLA25-100 | 25 | 65 | 100 | M18*2 | 2 |
| BT60-SLA32-105 | 32 | 72 | 105 | M20*2 | 2 |
| BT60-SLA40-110 | 40 | 80 | 110 | M20*2 | 2 |
| BT60-SLA50-125 | 50 | 98 | 125 | M24*2 | 2 |

AD/B Customized

AD/B 可定制

End Mill Holder with Coolant Channels 侧固刀柄，端面出水型

| | | | |
|--|---|--|---|
|  DIN6359/1835B |  A \nearrow ≤ 0.005 |  RPM G6.3/15000 |  AD |
|--|---|--|---|

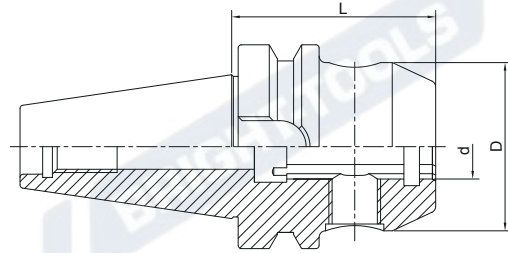



| Size | d | D | L | M | Screw Quantity |
|-----------------|----|----|-----|-------|----------------|
| BT40-SLA06-50K | 6 | 25 | 50 | M6 | 1 |
| BT40-SLA08-50K | 8 | 28 | 50 | M8 | 1 |
| BT40-SLA10-63K | 10 | 35 | 63 | M10 | 1 |
| BT40-SLA12-63K | 12 | 42 | 63 | M12 | 1 |
| BT40-SLA14-63K | 14 | 44 | 63 | M12 | 1 |
| BT40-SLA16-63K | 16 | 48 | 63 | M14 | 1 |
| BT40-SLA18-63K | 18 | 50 | 63 | M14 | 1 |
| BT40-SLA20-63K | 20 | 52 | 63 | M16 | 1 |
| BT40-SLA25-90K | 25 | 65 | 90 | M18*2 | 2 |
| BT40-SLA32-100K | 32 | 72 | 100 | M20*2 | 2 |
| BT40-SLA40-120K | 40 | 80 | 120 | M20*2 | 2 |
| BT40-SLA06-100K | 6 | 25 | 100 | M6 | 1 |
| BT40-SLA08-100K | 8 | 28 | 100 | M8 | 1 |
| BT40-SLA10-100K | 10 | 35 | 100 | M10 | 1 |
| BT40-SLA12-100K | 12 | 42 | 100 | M12 | 1 |
| BT40-SLA14-100K | 14 | 44 | 100 | M12 | 1 |
| BT40-SLA16-100K | 16 | 48 | 100 | M14 | 1 |
| BT40-SLA18-100K | 18 | 50 | 100 | M14 | 1 |
| BT40-SLA20-100K | 20 | 52 | 100 | M16 | 1 |

AD/B Customized

AD/B 可定制

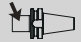
End Mill Holder with Coolant Channels 侧固刀柄，端面出水型

| | | | |
|---|--|-------------------|--|
|  DIN6359/1835B |  A \nearrow ≤ 0.005 | RPM G6.3/15000 |  AD |
|---|--|-------------------|--|

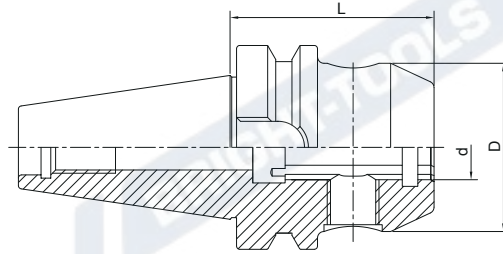

| Size | d | D | L | M | Screw Quantity |
|-----------------|----|----|-----|-------|----------------|
| BT50-SLA06-63K | 6 | 25 | 63 | M6 | 1 |
| BT50-SLA08-63K | 8 | 28 | 63 | M8 | 1 |
| BT50-SLA10-63K | 10 | 35 | 63 | M10 | 1 |
| BT50-SLA12-80K | 12 | 42 | 80 | M12 | 1 |
| BT50-SLA14-80K | 14 | 44 | 80 | M12 | 1 |
| BT50-SLA16-80K | 16 | 48 | 80 | M14 | 1 |
| BT50-SLA18-80K | 18 | 50 | 80 | M14 | 1 |
| BT50-SLA20-80K | 20 | 52 | 80 | M16 | 1 |
| BT50-SLA25-100K | 25 | 65 | 100 | M18*2 | 2 |
| BT50-SLA32-105K | 32 | 72 | 105 | M20*2 | 2 |
| BT50-SLA40-110K | 40 | 80 | 110 | M20*2 | 2 |
| BT50-SLA06-100K | 6 | 25 | 100 | M6 | 1 |
| BT50-SLA08-100K | 8 | 28 | 100 | M8 | 1 |
| BT50-SLA10-100K | 10 | 35 | 100 | M10 | 1 |
| BT50-SLA12-100K | 12 | 42 | 100 | M12 | 1 |
| BT50-SLA14-100K | 14 | 44 | 100 | M12 | 1 |
| BT50-SLA16-100K | 16 | 48 | 100 | M14 | 1 |
| BT50-SLA18-100K | 18 | 50 | 100 | M14 | 1 |
| BT50-SLA20-100K | 20 | 52 | 100 | M16 | 1 |

AD/B Customized

AD/B 可定制

End Mill Holder Whistle Notch
侧固式铣刀柄，斜 2 度



| | | | |
|----------|----------------|-------------------|----|
| DIN1835E | A ≤ 0.005 | RPM G6.3/15000 | AD |
|----------|----------------|-------------------|----|

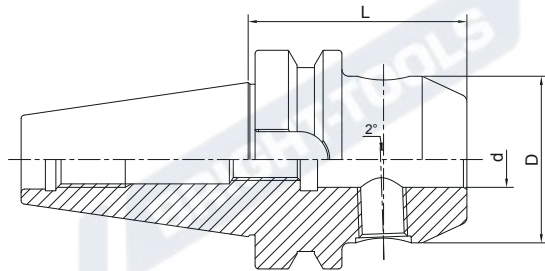

| Size | d | D | L | M | Screw Quantity |
|----------------|----|----|-----|-------|----------------|
| BT40-SLB06-50 | 6 | 25 | 50 | M6 | 1 |
| BT40-SLB08-50 | 8 | 28 | 50 | M8 | 1 |
| BT40-SLB10-63 | 10 | 35 | 63 | M10 | 1 |
| BT40-SLB12-63 | 12 | 42 | 63 | M12 | 1 |
| BT40-SLB14-63 | 14 | 44 | 63 | M12 | 1 |
| BT40-SLB16-63 | 16 | 48 | 63 | M14 | 1 |
| BT40-SLB18-63 | 18 | 50 | 63 | M14 | 1 |
| BT40-SLB20-63 | 20 | 52 | 63 | M16 | 1 |
| BT40-SLB25-90 | 25 | 65 | 90 | M18*2 | 2 |
| BT40-SLB32-100 | 32 | 72 | 100 | M20*2 | 2 |
| BT40-SLB40-120 | 40 | 80 | 120 | M20*2 | 2 |
| BT50-SLB06-63 | 6 | 25 | 63 | M6 | 1 |
| BT50-SLB08-63 | 8 | 28 | 63 | M8 | 1 |
| BT50-SLB10-63 | 10 | 35 | 63 | M10 | 1 |
| BT50-SLB12-80 | 12 | 42 | 80 | M12 | 1 |
| BT50-SLB14-80 | 14 | 44 | 80 | M12 | 1 |
| BT50-SLB16-80 | 16 | 48 | 80 | M14 | 1 |
| BT50-SLB18-80 | 18 | 50 | 80 | M14 | 1 |
| BT50-SLB20-80 | 20 | 52 | 80 | M16 | 1 |
| BT50-SLB25-100 | 25 | 65 | 100 | M18*2 | 2 |
| BT50-SLB32-105 | 32 | 72 | 105 | M20*2 | 2 |
| BT50-SLB40-110 | 40 | 80 | 110 | M20*2 | 2 |

AD/B Customized

AD/B 可定制

BT

Morse Taper Adapter with Tang

带扁尾莫氏刀柄

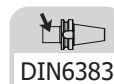
 DIN6383

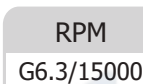
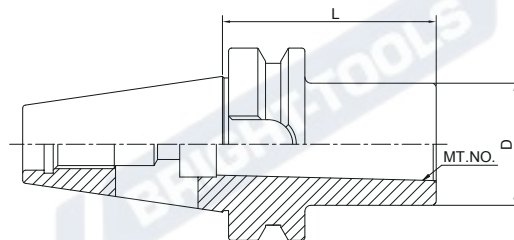

 A ≤ 0.005

 RPM
G6.3/15000

| Size | MT.NO. | D | L |
|---------------|--------|----|-----|
| BT30-MTA1-45 | 1 | 25 | 45 |
| BT30-MTA2-60 | 2 | 32 | 60 |
| BT30-MTA3-75 | 3 | 40 | 75 |
| BT40-MTA1-50 | 1 | 25 | 50 |
| BT40-MTA2-50 | 2 | 32 | 50 |
| BT40-MTA3-70 | 3 | 40 | 70 |
| BT40-MTA4-95 | 4 | 48 | 95 |
| BT50-MTA1-45 | 1 | 25 | 45 |
| BT50-MTA2-60 | 2 | 32 | 60 |
| BT50-MTA3-65 | 3 | 40 | 65 |
| BT50-MTA3-180 | 3 | 40 | 180 |
| BT50-MTA4-95 | 4 | 48 | 95 |
| BT50-MTA4-180 | 4 | 48 | 180 |
| BT50-MTA5-105 | 5 | 63 | 105 |
| BT60-MTA3-65 | 3 | 40 | 65 |
| BT60-MTA4-95 | 4 | 48 | 95 |
| BT60-MTA5-105 | 5 | 63 | 105 |
| BT60-MTA6-170 | 6 | 85 | 170 |

Morse Taper Adapter with Drawbar
带螺纹孔莫氏刀柄

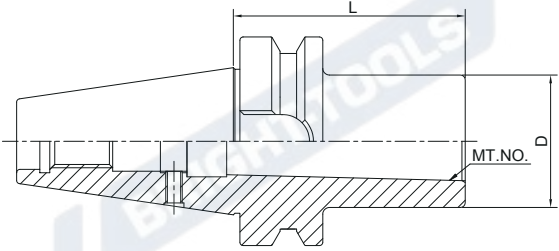

| | | |
|---|--|-------------------|
|  DIN6364 |  A \nearrow ≤ 0.005 | RPM G6.3/15000 |
|---|--|-------------------|



| Size | MT.NO. | D | L |
|---------------|--------|----|-----|
| BT40-MTB1-50 | 1 | 25 | 50 |
| BT40-MTB2-50 | 2 | 32 | 50 |
| BT40-MTB3-70 | 3 | 40 | 70 |
| BT40-MTB4-95 | 4 | 48 | 95 |
| | | | |
| BT50-MTB1-45 | 1 | 25 | 45 |
| BT50-MTB2-60 | 2 | 32 | 60 |
| BT50-MTB3-65 | 3 | 40 | 65 |
| BT50-MTB4-70 | 4 | 48 | 70 |
| BT50-MTB5-120 | 5 | 63 | 120 |
| | | | |
| BT60-MTB2-60 | 2 | 32 | 60 |
| BT60-MTB3-65 | 3 | 40 | 65 |
| BT60-MTB4-70 | 4 | 48 | 70 |
| BT60-MTB5-120 | 5 | 63 | 120 |
| BT60-MTB6-150 | 6 | 85 | 150 |

BT

Tool Holder Adapter Sleeve 转换刀柄



| | |
|--------|------------|
| A ↗ | RPM |
| ≤0.005 | G6.3/15000 |

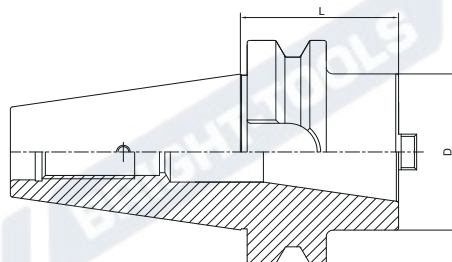

| Size | D | L |
|---------------|----|-----|
| BT40-BT30-60 | 63 | 60 |
| BT40-BT40-100 | 63 | 100 |
| BT50-BT40-70 | 70 | 70 |
| BT50-BT50-120 | 97 | 120 |

Tool Holder Adapter Sleeve 转换刀柄



| | |
|--------|----|
| A ↗ | AD |
| ≤0.005 | |

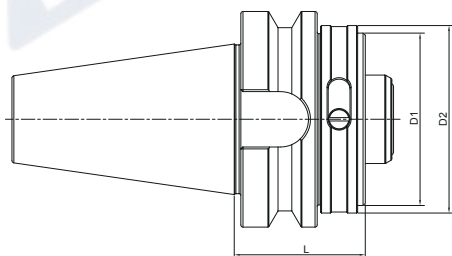

| Size | D1 | D2 | L |
|-----------------|-----|-----|----|
| BT30-HSK32C-40 | 32 | 37 | 40 |
| BT30-HSK40C-40 | 40 | 45 | 40 |
| BT40-HSK32C-40 | 32 | 37 | 40 |
| BT40-HSK40C-40 | 40 | 45 | 40 |
| BT40-HSK50C-50 | 50 | 55 | 50 |
| BT40-HSK63C-70 | 63 | 70 | 70 |
| BT50-HSK32C-50 | 32 | 37 | 50 |
| BT50-HSK40C-50 | 40 | 45 | 50 |
| BT50-HSK50C-60 | 50 | 55 | 60 |
| BT50-HSK63C-60 | 63 | 70 | 60 |
| BT50-HSK80C-60 | 80 | 87 | 60 |
| BT50-HSK100C-90 | 100 | 110 | 90 |

Drill Chuck Adapter
钻接杆



| | | |
|--------|------------------------------|-------------------|
| DIN238 | A \nearrow ≤ 0.005 | RPM G6.3/15000 |
|--------|------------------------------|-------------------|

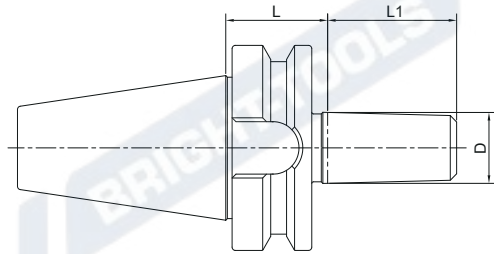

| Size | D | L | L1 |
|-------------|-----|----|------|
| BT30-B12-25 | B12 | 25 | 18.5 |
| BT30-B16-25 | B16 | 25 | 24 |
| BT40-B12-32 | B12 | 32 | 18.5 |
| BT40-B16-32 | B16 | 32 | 24 |
| BT40-B18-32 | B18 | 32 | 32 |
| BT40-B22-32 | B22 | 32 | 40.5 |
| BT50-B16-45 | B16 | 45 | 24 |
| BT50-B18-45 | B18 | 45 | 32 |
| BT50-B22-45 | B22 | 45 | 40.5 |

APU Drill Chuck Holder
APU 钻夹头刀柄

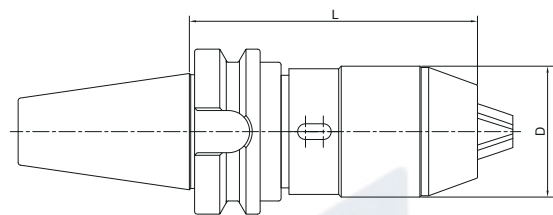

| Size | D | L | Capacity |
|----------------|----|-----|----------|
| BT30-APU08-80 | 36 | 80 | 1-8 |
| BT30-APU13-110 | 48 | 110 | 1-13 |
| BT40-APU08-85 | 36 | 85 | 1-8 |
| BT40-APU13-105 | 48 | 105 | 1-13 |
| BT40-APU16-110 | 53 | 110 | 3-16 |
| BT50-APU08-90 | 36 | 90 | 1-8 |
| BT50-APU13-105 | 48 | 105 | 1-13 |
| BT50-APU16-115 | 53 | 115 | 3-16 |

BT

Precision Drill Chuck Holder 精密钻夹头刀柄

| | |
|-------|------------|
| A ↗ | RPM |
| ≤0.03 | G6.3/15000 |

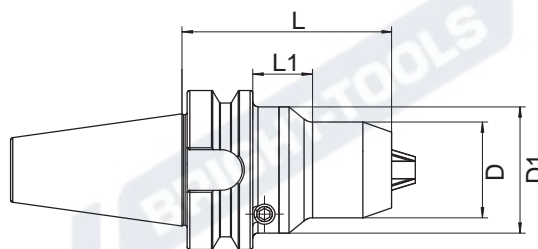

| Size | D | D1 | L | L1 | Capacity |
|----------------|----|----|-----|----|----------|
| BT30-CPU10-80 | 38 | 50 | 80 | 26 | 1-10 |
| BT40-CPU10-80 | 38 | 50 | 80 | 21 | 1-10 |
| BT40-CPU13-90 | 50 | - | 90 | - | 1-13 |
| BT40-CPU16-90 | 50 | - | 90 | - | 1-16 |
| BT50-CPU13-100 | 50 | - | 100 | - | 1-13 |
| BT50-CPU16-100 | 50 | - | 100 | - | 1-16 |

Quick Change Tapping Chuck with Length Compensation 弹性快换攻丝刀柄

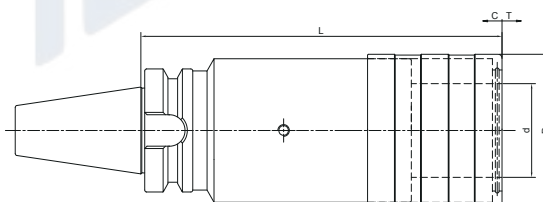

| Size | d | D | L | T | C |
|-----------------|----|----|-----|------|------|
| BT30-TC312-70 | 19 | 38 | 70 | 7.5 | 7.5 |
| BT30-TC820-95 | 31 | 54 | 95 | 12.5 | 12.5 |
| BT40-TC312-65 | 19 | 38 | 65 | 7.5 | 7.5 |
| BT40-TC820-93 | 31 | 53 | 93 | 12.5 | 12.5 |
| BT40-TC1433-166 | 48 | 78 | 166 | 22 | 22 |
| BT50-TC312-100 | 19 | 38 | 100 | 7.5 | 7.5 |
| BT50-TC820-100 | 31 | 53 | 100 | 12.5 | 12.5 |
| BT50-TC1433-142 | 48 | 78 | 142 | 22 | 22 |

Screw-in Milling Cutter Holder
锁牙刀柄, 锥柄型



| | | |
|---------------|-------------------|----|
| A ↗ ≤0.005 | RPM G6.3/15000 | AD |
|---------------|-------------------|----|

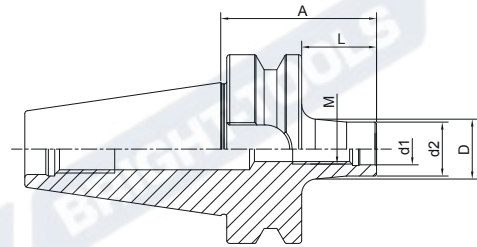

| Size | M | d1 | d2 | A | L | D |
|----------------------|----|------|------|-----|-----|------|
| BT40-SOM08-52 L=25 | 8 | 8.5 | 14.5 | 52 | 25 | 15 |
| BT40-SOM08-77 L=50 | 8 | 8.5 | 14.5 | 77 | 50 | 23 |
| BT40-SOM08-102 L=75 | 8 | 8.5 | 14.5 | 102 | 75 | 23 |
| BT40-SOM08-127 L=100 | 8 | 8.5 | 14.5 | 127 | 100 | 25 |
| | | | | | | |
| BT40-SOM10-32 L=5 | 10 | 10.5 | 18 | 32 | 5 | 18 |
| BT40-SOM10-52 L=25 | 10 | 10.5 | 18 | 52 | 25 | 20 |
| BT40-SOM10-77 L=50 | 10 | 10.5 | 18 | 77 | 50 | 23 |
| BT40-SOM10-102 L=75 | 10 | 10.5 | 18 | 102 | 75 | 28 |
| BT40-SOM10-127 L=100 | 10 | 10.5 | 18 | 127 | 100 | 32 |
| BT40-SOM10-177 L=150 | 10 | 10.5 | 18 | 177 | 150 | 36.5 |
| | | | | | | |
| BT40-SOM12-32 L=5 | 12 | 12.5 | 21 | 32 | 5 | 21 |
| BT40-SOM12-52 L=25 | 12 | 12.5 | 21 | 52 | 25 | 24 |
| BT40-SOM12-77 L=50 | 12 | 12.5 | 21 | 77 | 50 | 24 |
| BT40-SOM12-102 L=75 | 12 | 12.5 | 21 | 102 | 75 | 31 |
| BT40-SOM12-127 L=100 | 12 | 12.5 | 21 | 127 | 100 | 31 |
| BT40-SOM12-152 L=125 | 12 | 12.5 | 21 | 152 | 125 | 36 |
| BT40-SOM12-177 L=150 | 12 | 12.5 | 21 | 177 | 150 | 38 |
| | | | | | | |
| BT40-SOM16-32 L=5 | 16 | 17 | 29 | 32 | 5 | 29 |
| BT40-SOM16-52 L=25 | 16 | 17 | 29 | 52 | 25 | 29 |
| BT40-SOM16-77 L=50 | 16 | 17 | 29 | 77 | 50 | 34 |
| BT40-SOM16-102 L=75 | 16 | 17 | 29 | 102 | 75 | 34 |
| BT40-SOM16-127 L=100 | 16 | 17 | 29 | 127 | 100 | 36 |
| BT40-SOM16-152 L=125 | 16 | 17 | 29 | 152 | 125 | 40 |
| BT40-SOM16-177 L=150 | 16 | 17 | 29 | 177 | 150 | 42.5 |
| | | | | | | |
| BT50-SOM08-88 L=50 | 8 | 8.5 | 14.5 | 88 | 50 | 23 |
| BT50-SOM08-138 L=100 | 8 | 8.5 | 14.5 | 138 | 100 | 25 |
| BT50-SOM08-188 L=150 | 8 | 8.5 | 14.5 | 188 | 150 | 30 |
| | | | | | | |
| BT50-SOM10-88 L=50 | 10 | 10.5 | 18 | 88 | 50 | 23 |
| BT50-SOM10-138 L=100 | 10 | 10.5 | 18 | 138 | 100 | 32 |
| BT50-SOM10-188 L=150 | 10 | 10.5 | 18 | 188 | 150 | 36.5 |

BT

Screw-inMilling Cutter Holder

锁牙刀柄, 锥柄型



| | | |
|----------------------|--------------------------|--|
| A ↗ ≤0.005 | RPM G6.3/15000 |  AD |
|----------------------|--------------------------|--|

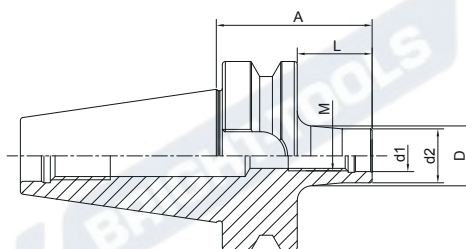

| Size | M | d1 | d2 | A | L | D |
|----------------------|----|------|----|-----|-----|------|
| BT50-SOM12-88 L=50 | 12 | 12.5 | 21 | 88 | 50 | 24 |
| BT50-SOM12-138 L=100 | 12 | 12.5 | 21 | 138 | 100 | 33 |
| BT50-SOM12-188 L=150 | 12 | 12.5 | 21 | 188 | 150 | 40 |
| BT50-SOM16-88 L=50 | 16 | 17 | 29 | 88 | 50 | 34 |
| BT50-SOM16-138 L=100 | 16 | 17 | 29 | 138 | 100 | 36 |
| BT50-SOM16-188 L=150 | 16 | 17 | 29 | 188 | 150 | 42.5 |

Screw-in Milling Cutter Holder

锁牙刀柄, 直柄型



| | | |
|----------------------|--------------------------|---|
| A ↗ ≤0.005 | RPM G6.3/15000 |  AD |
|----------------------|--------------------------|---|

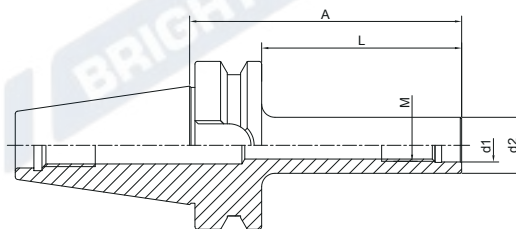

| Size | M | d1 | d2 | A | L |
|--------------------|----|------|----|-----|-----|
| BT40-M10-102 L=75 | 10 | 10.5 | 18 | 102 | 75 |
| BT40-M10-127 L=100 | 10 | 10.5 | 18 | 127 | 100 |
| BT40-M10-177 L=150 | 10 | 10.5 | 18 | 177 | 150 |
| BT40-M12-102 L=75 | 12 | 12.5 | 21 | 102 | 75 |
| BT40-M12-127 L=100 | 12 | 12.5 | 21 | 127 | 100 |
| BT40-M12-152 L=125 | 12 | 12.5 | 21 | 152 | 125 |
| BT40-M12-177 L=150 | 12 | 12.5 | 21 | 177 | 150 |
| BT40-M16-102 L=75 | 16 | 17 | 29 | 102 | 75 |
| BT40-M16-127 L=100 | 16 | 17 | 29 | 127 | 100 |
| BT40-M16-152 L=125 | 16 | 17 | 29 | 152 | 125 |
| BT40-M16-177 L=150 | 16 | 17 | 29 | 177 | 150 |
| BT50-M10-138 L=100 | 10 | 10.5 | 18 | 138 | 100 |
| BT50-M10-188 L=150 | 10 | 10.5 | 18 | 188 | 150 |
| BT50-M12-138 L=100 | 12 | 12.5 | 21 | 138 | 100 |
| BT50-M12-188 L=150 | 12 | 12.5 | 21 | 188 | 150 |
| BT50-M16-138 L=100 | 16 | 17 | 29 | 138 | 100 |
| BT50-M16-188 L=150 | 16 | 17 | 29 | 188 | 150 |

Runout Adjustable Flange Adapter
可调节精度法兰刀柄

| | | |
|---------------|-------------------|----|
| A ↗ ≤0.002 | RPM G2.5/25000 | AD |
|---------------|-------------------|----|

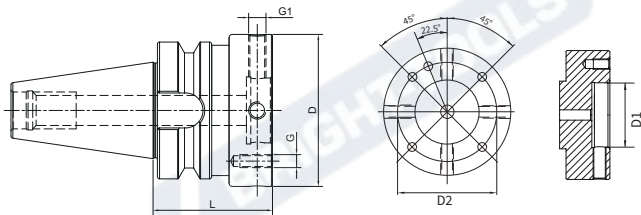

| Size | D | D1 | D2 | L | G | G1 |
|-----------------|-----|----|-----|----|-----|-------|
| BT30-MOD060-050 | 60 | 30 | 44 | 50 | M5 | M8x1 |
| BT30-MOD070-050 | 70 | 35 | 53 | 50 | M6 | M8x1 |
| BT40-MOD060-050 | 60 | 30 | 44 | 50 | M5 | M8x1 |
| BT40-MOD070-050 | 70 | 35 | 53 | 50 | M6 | M8x1 |
| BT40-MOD080-050 | 80 | 40 | 63 | 50 | M6 | M8x1 |
| BT40-MOD100-070 | 100 | 50 | 79 | 70 | M8 | M10x1 |
| BT50-MOD060-070 | 60 | 30 | 44 | 70 | M5 | M8x1 |
| BT50-MOD070-070 | 70 | 35 | 53 | 70 | M6 | M8x1 |
| BT50-MOD080-070 | 80 | 40 | 63 | 70 | M6 | M8x1 |
| BT50-MOD100-070 | 100 | 50 | 79 | 70 | M8 | M10x1 |
| BT50-MOD117-080 | 117 | 60 | 96 | 80 | M8 | M10x1 |
| BT50-MOD140-080 | 140 | 80 | 119 | 80 | M10 | M10x1 |

BT

UM Adjustable Tool Holder

UM 调零刀柄

| | | |
|---------------|-------------------|----|
| A ↗ ≤0.003 | RPM G2.5/25000 | AD |
|---------------|-------------------|----|

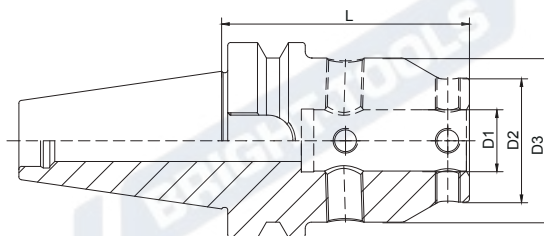

| Size | D1 | D2 | D3 | L |
|---------------|----|----|------|-----|
| BT30-UM12-65 | 12 | 28 | 44.5 | 65 |
| BT30-UM16-75 | 16 | 32 | 48 | 75 |
| BT30-UM20-85 | 20 | 40 | 53 | 85 |
| BT30-UM25-95 | 25 | 48 | 63 | 95 |
| BT30-UM32-100 | 32 | 52 | 63 | 100 |
| BT40-UM12-70 | 12 | 28 | 44.5 | 70 |
| BT40-UM16-70 | 16 | 32 | 48 | 70 |
| BT40-UM20-80 | 20 | 40 | 53 | 80 |
| BT40-UM25-100 | 25 | 48 | 63 | 100 |
| BT40-UM32-95 | 32 | 52 | 63 | 95 |
| BT50-UM12-80 | 12 | 28 | 44.5 | 80 |
| BT50-UM16-85 | 16 | 32 | 48 | 85 |
| BT50-UM20-90 | 20 | 40 | 53 | 90 |
| BT50-UM25-105 | 25 | 48 | 63 | 105 |
| BT50-UM32-105 | 32 | 52 | 63 | 105 |

Boring Bar Blank 基础柄

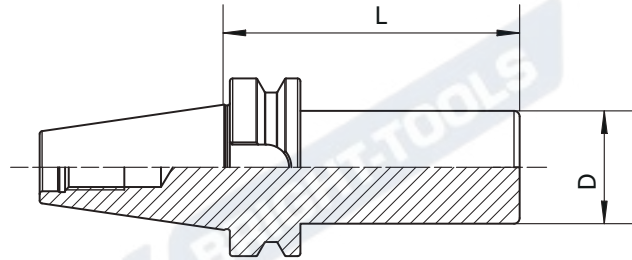

| Size | D | L |
|---------------|-----|-----|
| BT30-D50-160 | 50 | 160 |
| BT40-D63-160 | 63 | 160 |
| BT40-D63-250 | 63 | 250 |
| BT50-D100-160 | 100 | 160 |
| BT50-D100-250 | 100 | 250 |

Test Arbor 主轴检测棒

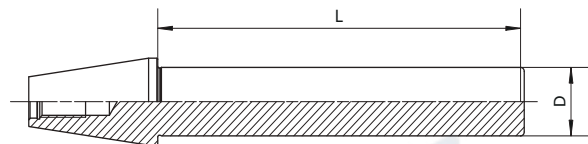

A ↗
≤0.002

| Size | D | L |
|-------------|----|-----|
| BT30-32-300 | 32 | 300 |
| BT40-40-300 | 40 | 300 |
| BT50-50-300 | 50 | 300 |

Alignment Tool for ATC Arm 调整机械手用组合模具

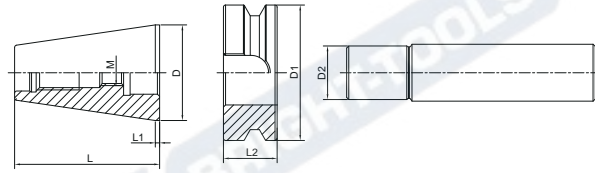

| Size | D | D1 | D2 | L | L1 | L2 |
|--------------|-------|-----|----|-------|----|----|
| BT30-ATC-18D | 31.75 | 46 | 18 | 50.4 | 2 | 20 |
| BT40-ATC-20D | 44.45 | 63 | 20 | 67.4 | 2 | 25 |
| BT50-ATC-28D | 69.85 | 100 | 28 | 104.8 | 3 | 35 |

Usage:

- 1) Put the Taper to the machine Spindle
- 2) Install flange to the ATC arm
- 3) Insert Pin into the flange
- 4) Adjust ATC arm and make sure the pin front part into the flange completely.

使用方法:

- 1) 将锥度安装到机床主轴上
- 2) 将法兰安装到 ATC 臂上
- 3) 将销钉插入法兰中
- 4) 调整 ATC 臂并确保销钉前部完全进入法兰中。

Alignment Tool for ATC Arm 调整机械手用组合模具

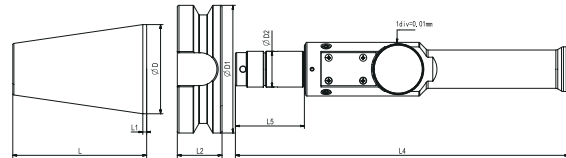
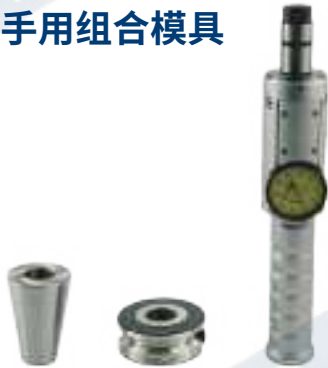

| Size | D | D1 | D2 | L | L1 | L2 | L4 | L5 |
|------------|-------|-----|----|-------|----|----|-----|----|
| BT30-ATC18 | 31.75 | 46 | 18 | 50.4 | 2 | 20 | 251 | 44 |
| BT40-ATC20 | 44.45 | 63 | 20 | 67.4 | 2 | 25 | 251 | 44 |
| BT50-ATC28 | 69.85 | 100 | 28 | 104.8 | 3 | 35 | 261 | 54 |

Usage:

1. Install the calibration taper to the machine spindle.
2. Install the calibration flange on the ATC machine.
3. Insert the calibration pin into the calibration flange.
4. Rotate the calibration pin to find the maximum and minimum positions of the pointer.
value position of the pointer. This direction is the direction of eccentricity, and the amount of eccentricity is half of the difference.
5. Adjust the ATC manipulator and ensure that the front of the calibration pin is fully inserted into the flange.

使用方法

1. 将校正锥柄安装到机床主轴。
2. 将校正法兰安装在 ATC 机械手上。
3. 将校正销棒插入校正法兰。
4. 旋转校正销棒，找到指针的最大值位置和最小值位置。
该方向即偏心方向，偏心量为差值的一半。
5. 调整 ATC 机械手并确保校正销棒前端完全插入法兰中。

BRIGHT-TOOLS

BRIGHT-TOOLS

TOOL HOLDERS

BBT

BRIGHT-TOOLS

BRIGHT-TOOLS

BRIGHT-TOOLS

BRIGHT-TOOLS

BBT DualDrive (Double Contact) Tool Holders



BBT Advantages:

- * Improve tool holder stability when high speed working.
- * Improve workpiece surface finish.
- * Improve working dimension accuracy.
- * Improve ATC repeatability.
- * Improve the roundness when boring operation.
- * Extend cutting tool life.

ORDER SPECIFICATION:
PLEASE ORDER BBT SPINDLE FOR BETTER PERFORMANCE.

BBT 双接触刀柄

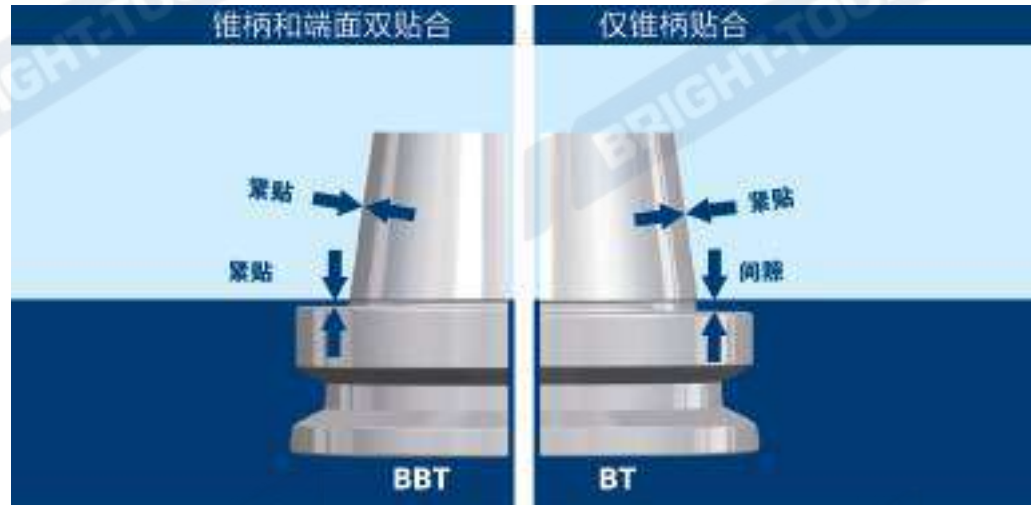

使用 BBT 双接触刀柄优势：

- * 高速加工时提高刀柄稳定性；
- * 提高工件表面光洁度；
- * 提高加工精度；
- * 提高 ATC 的重复精度；
- * 提高镗孔加工圆度；
- * 增加刀具使用寿命。

订购说明：

为了更好的使用效果，请订购带 BBT 主轴的加工中心。

BBT Taper Standard

BBT 锥柄标准

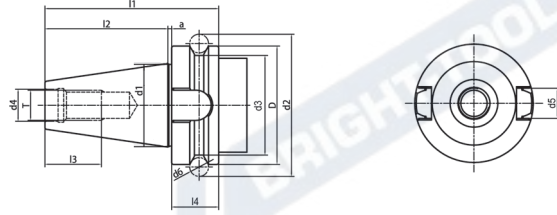
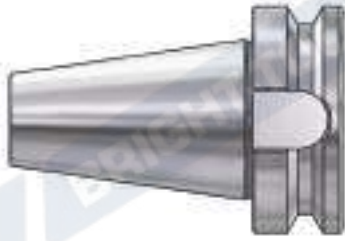

| Size | D | d1 | d2 | d3 | d4 | d5 | d6 | l1 | l2 | l3 | l4 | a | T |
|-------|-----|-------|---------|----|------|------|----|-------|-------|----|------|-----|----------|
| BBT30 | 46 | 31.75 | 56.14 | 38 | 12.5 | 16.1 | 8 | 70.4 | 48.4 | 24 | 21 | 1 | M12*1.75 |
| BBT40 | 63 | 44.45 | 75.679 | 53 | 17 | 16.1 | 10 | 92.4 | 65.4 | 30 | 26 | 1 | M16*2.0 |
| BBT50 | 100 | 69.85 | 119.019 | 85 | 25 | 25.7 | 15 | 139.8 | 101.8 | 45 | 36.5 | 1.5 | M24*3.0 |

Taper standard: JIS B 6339

Material: Alloyed case hardened steel

Surface Treatment: Blackening and Bright

Taper tolerance: <AT3

Hardness: HRC 56-60

Carbon depth: 0.8±0.2mm

Surface Roughness: Ra<0.2µm

Balancing: G6.3/15000; G2.5/25000

Cooling: AD; AD/B can be made by request.

BBT TOOLING SYSTEM

BBT 工具系统

| | |
|--|------|
| ER Collet Chuck..... | D.46 |
| ER 弹簧夹头刀柄 | |
| Power Milling Chuck | D.48 |
| 强力铣刀柄 | |
| SKS Collet Chuck..... | D.50 |
| SKS 高速筒夹刀柄 | |
| Precision Screw Collet Chuck..... | D.51 |
| NDC后拉刀柄 | |
| Face Mill Holder..... | D.52 |
| 面铣刀柄 | |
| Combi Shell Mill Holder..... | D.54 |
| 混合插入式铣刀柄 | |
| End Mill Holder..... | D.56 |
| 侧固刀柄 | |
| Morse Taper Adapter..... | D.56 |
| 带扁尾莫氏刀柄 | |
| Tool Holder Adatper Sleeve | D.56 |
| 转换刀柄 | |
| Precision Drill Chuck Holder..... | D.57 |
| 精密钻夹头刀柄 | |
| Runout Adjustable Flange Adapter | D.57 |
| 可调节精度法兰刀柄 | |
| Test Arbor..... | D.58 |
| 主轴检测棒 | |



ER Collet Chuck with UM Nut

ER 弹簧夹头刀柄

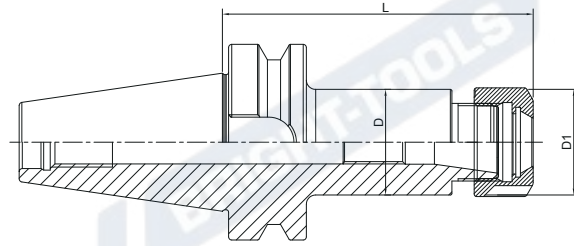
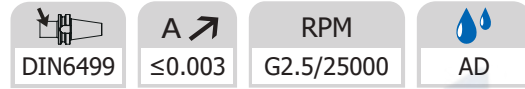

| Size | D | D1 | L | Capacity |
|------------------|----|----|-----|----------|
| BBT40-ER16UM-70 | 28 | 32 | 70 | 1-10 |
| BBT40-ER20UM-70 | 34 | 35 | 70 | 1-13 |
| BBT40-ER25-70 | 42 | 42 | 70 | 2-16 |
| BBT40-ER32-70 | 50 | 50 | 70 | 2-20 |
| BBT40-ER40-80 | 50 | 63 | 80 | 3-26 |
| | | | | |
| BBT40-ER16UM-100 | 28 | 32 | 100 | 1-10 |
| BBT40-ER20UM-100 | 34 | 35 | 100 | 1-13 |
| BBT40-ER25-100 | 42 | 42 | 100 | 2-16 |
| BBT40-ER32-100 | 50 | 50 | 100 | 2-20 |
| BBT40-ER40-100 | 50 | 63 | 100 | 3-26 |
| | | | | |
| BBT40-ER16UM-160 | 28 | 32 | 160 | 1-10 |
| BBT40-ER20UM-160 | 34 | 35 | 160 | 1-13 |
| BBT40-ER25-160 | 42 | 42 | 160 | 2-16 |
| BBT40-ER32-160 | 50 | 50 | 160 | 2-20 |
| BBT40-ER40-160 | 50 | 63 | 160 | 3-26 |
| | | | | |
| BBT50-ER16UM-70 | 28 | 32 | 70 | 1-10 |
| BBT50-ER20UM-70 | 34 | 35 | 70 | 1-13 |
| BBT50-ER25-70 | 42 | 42 | 70 | 2-16 |
| BBT50-ER32-70 | 40 | 50 | 70 | 2-20 |
| BBT50-ER40-80 | 63 | 63 | 80 | 3-26 |
| BBT50-ER50-100 | 64 | 78 | 100 | 6-34 |
| | | | | |
| BBT50-ER16UM-100 | 28 | 32 | 100 | 1-10 |
| BBT50-ER20UM-100 | 34 | 35 | 100 | 1-13 |
| BBT50-ER25-100 | 42 | 42 | 100 | 2-16 |
| BBT50-ER32-100 | 50 | 50 | 100 | 2-20 |
| BBT50-ER40-100 | 63 | 63 | 100 | 3-26 |
| | | | | |
| BBT50-ER16UM-160 | 28 | 32 | 160 | 1-10 |
| BBT50-ER20UM-160 | 34 | 35 | 160 | 1-13 |
| BBT50-ER25-160 | 42 | 42 | 160 | 2-16 |
| BBT50-ER32-160 | 50 | 50 | 160 | 2-20 |
| BBT50-ER40-160 | 63 | 63 | 160 | 3-26 |

ER Collet Chuck with Hex Nut
ER 弹簧夹头刀柄



| | | | |
|---------|------------------------|-------------------|----|
| DIN6499 | A \nearrow ≤0.003 | RPM G2.5/25000 | AD |
|---------|------------------------|-------------------|----|

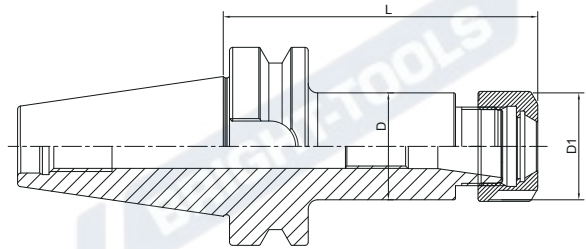

| Size | D | D1 | L | Capacity |
|----------------|----|----|-----|----------|
| BBT40-ER16-70 | 28 | 28 | 70 | 1-10 |
| BBT40-ER20-70 | 34 | 34 | 70 | 1-13 |
| BBT40-ER16-100 | 28 | 28 | 100 | 1-10 |
| BBT40-ER20-100 | 34 | 34 | 100 | 1-13 |
| BBT40-ER16-160 | 28 | 28 | 160 | 1-10 |
| BBT40-ER20-160 | 34 | 34 | 160 | 1-13 |
| BBT50-ER16-70 | 28 | 28 | 70 | 1-10 |
| BBT50-ER20-70 | 34 | 34 | 70 | 1-13 |
| BBT50-ER16-100 | 28 | 28 | 100 | 1-10 |
| BBT50-ER20-100 | 34 | 34 | 100 | 1-13 |
| BBT50-ER16-160 | 28 | 28 | 160 | 1-10 |
| BBT50-ER20-160 | 34 | 34 | 160 | 1-13 |

BBT

ER Collet Chuck with Mini Nut

ER 弹簧夹头刀柄

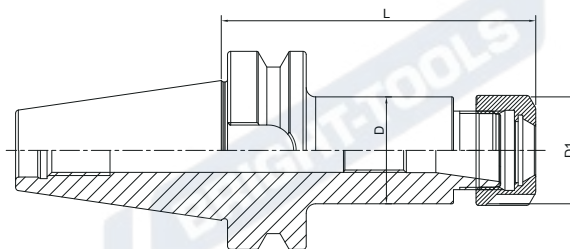
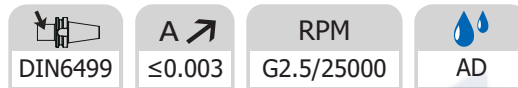

| Size | D | D1 | L | Capacity |
|------------------|----|----|-----|----------|
| BBT40-ER11M-70 | 16 | 16 | 70 | 1-7 |
| BBT40-ER16M-70 | 22 | 22 | 70 | 1-10 |
| BBT40-ER20M-70 | 28 | 28 | 70 | 1-13 |
| BBT40-ER25M-70 | 35 | 35 | 70 | 2-16 |
| BBT40-ER11M-100 | 16 | 16 | 100 | 1-7 |
| BBT40-ER16M-100 | 22 | 22 | 100 | 1-10 |
| BBT40-ER20M-100 | 28 | 28 | 100 | 1-13 |
| BBT40-ER25M-100 | 35 | 35 | 100 | 2-16 |
| BBT40-ER11M-160T | 16 | 16 | 160 | 1-7 |
| BBT40-ER16M-160T | 22 | 22 | 160 | 1-10 |
| BBT40-ER20M-160 | 28 | 28 | 160 | 1-13 |
| BBT40-ER25M-160 | 35 | 35 | 160 | 2-16 |

T refers to cutter side with taper design

T 代表刀具端锥柄设计

Power Milling Chuck

强力铣刀柄

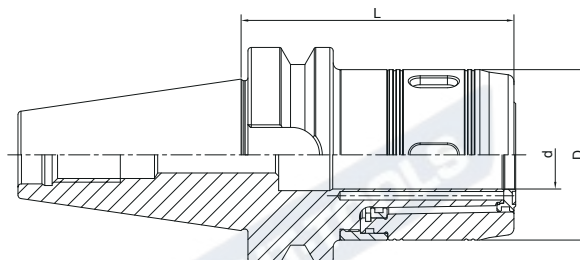

| Size | d | D | L | Capacity |
|----------------|----|----|-----|----------|
| BBT40-HC20-90 | 20 | 50 | 90 | 3-16; 20 |
| BBT40-HC25-100 | 25 | 59 | 100 | 3-20; 25 |
| BBT40-HC32-105 | 32 | 72 | 105 | 3-25; 32 |
| BBT50-HC20-105 | 20 | 50 | 105 | 3-16; 20 |
| BBT50-HC25-105 | 25 | 59 | 105 | 3-20; 25 |
| BBT50-HC32-110 | 32 | 72 | 110 | 3-25; 32 |

Power Milling Chuck
強力铣刀柄

NEW

A ↗
 ≤0.005

AD



Type 1

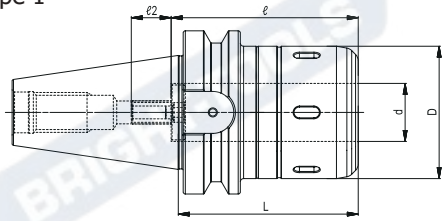

Type 2

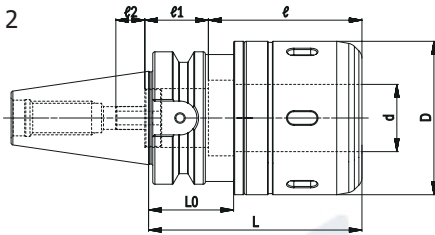

Type 3

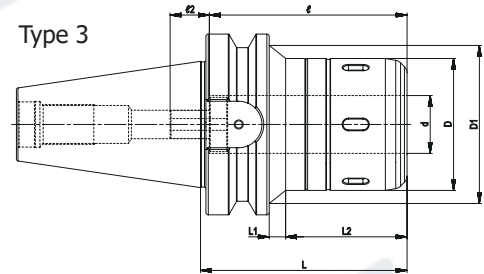

| Size | Type | d | D | D1 | L | L1 | L2 | ℓ | ℓ1 | ℓ2 | d1 | L0 | G |
|------------------|------|----|----|----|-----|----|----|-----|----|----|----|----|-----|
| BBT40-CT20SA-90 | 1 | 20 | 52 | - | 90 | - | - | 80 | - | 15 | - | - | M12 |
| BBT40-CT25SA-90 | 1 | 25 | 61 | - | 90 | - | - | 80 | - | 15 | - | - | M12 |
| BBT40-CT25SA-105 | 1 | 25 | 61 | - | 105 | - | - | 80 | - | 15 | - | - | M12 |
| BBT40-CT32SA-90 | 2 | 32 | 73 | - | 90 | - | - | 76 | 32 | 17 | 26 | 31 | M18 |
| BBT40-CT32SA-105 | 2 | 32 | 73 | - | 105 | - | - | 85 | 23 | 17 | 26 | 44 | M18 |
| BBT40-CT32SA-135 | 2 | 32 | 73 | - | 135 | - | - | 120 | - | 17 | - | 69 | M18 |
| BBT50-CT20SA-105 | 3 | 20 | 52 | 70 | 105 | 9 | 58 | 80 | - | 15 | - | - | M12 |
| BBT50-CT25SA-105 | 3 | 25 | 61 | 82 | 105 | 11 | 56 | 80 | - | 15 | - | - | M12 |
| BBT50-CT32SA-110 | 1 | 32 | 73 | - | 110 | - | - | 120 | - | 20 | - | - | M18 |

High Speed SKS Collet Chuck

SKS 高速筒夹刀柄

| | | |
|---------------|-------------------|---|
| A ↗ ≤0.003 | RPM G2.5/25000 |  AD |
|---------------|-------------------|---|

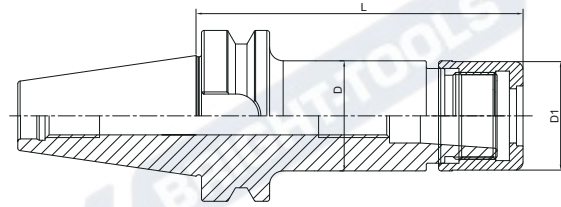

| Size | D | D1 | L | Capacity | M |
|-----------------|------|------|-----|----------|---------|
| BBT40-SKS10-90 | 27.5 | 27.1 | 90 | 2-10 | M21.5*1 |
| BBT40-SKS16-90 | 40.6 | 40 | 90 | 3-16 | M32*1.5 |
| BBT40-SKS20-90 | 48.5 | 48 | 90 | 2-20 | M40*1 |
| BBT40-SKS25-90 | 55.6 | 55 | 90 | 6-25 | M45*1.5 |
| | | | | | |
| BBT40-SKS10-120 | 27.5 | 27.1 | 120 | 2-10 | M21.5*1 |
| BBT40-SKS16-120 | 40.6 | 40 | 120 | 3-16 | M32*1.5 |
| BBT40-SKS20-120 | 48.5 | 48 | 120 | 2-20 | M40*1 |
| BBT40-SKS25-120 | 55.6 | 55 | 120 | 6-25 | M45*1.5 |

Precision Screw Collet Chuck
NDC 后拉刀柄

| | | |
|---------------|-------------------|----|
| A ↗ ≤0.003 | RPM G2.5/25000 | AD |
|---------------|-------------------|----|

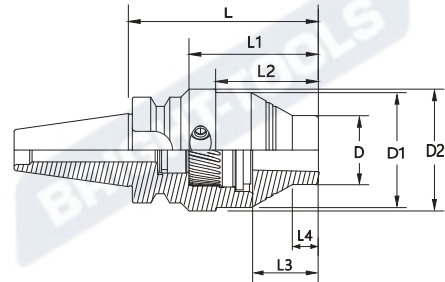

| Size | D | D1 | D2 | L | L1 | L2 | L3 | L4 | Capacity |
|-----------------|----|----|----|-----|-----|----|----|----|----------|
| BBT30-NDC14-80 | 30 | 50 | 53 | 80 | 56 | 43 | 26 | 11 | 4-14 |
| BBT30-NDC14-130 | 24 | 30 | 53 | 130 | 105 | 78 | 60 | - | 4-14 |
| BBT30-NDC20-80 | 40 | 53 | - | 80 | 56 | 28 | 19 | - | 4-20 |
| BBT40-NDC20-70 | 40 | 63 | - | 70 | 38 | 18 | - | - | 4-20 |
| BBT40-NDC20-120 | 40 | 63 | - | 120 | 89 | 68 | - | - | 4-20 |
| BBT40-NDC14-70 | 30 | 50 | - | 70 | 43 | 28 | 11 | - | 4-14 |
| BBT40-NDC14-120 | 24 | 30 | 53 | 120 | 93 | 78 | 61 | - | 4-14 |
| BBT40-NDC32-110 | 53 | 63 | - | 110 | 14 | - | - | - | 12-32 |
| BBT50-NDC20-130 | 34 | 55 | 70 | 130 | 93 | 81 | 73 | 24 | 4-20 |
| BBT50-NDC32-145 | 60 | 70 | - | 145 | 108 | 14 | - | - | 12-32 |

Face Mill Holder 面铣刀柄

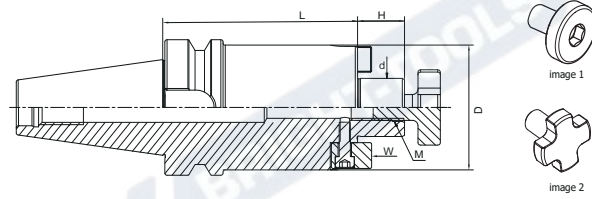
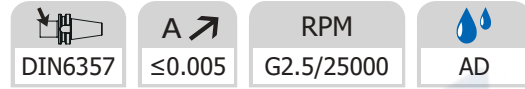

| Size | d | L | D | H | M |
|-----------------|----|-----|----|----|-----|
| BBT40-FMB16-40 | 16 | 40 | 38 | 17 | M8 |
| BBT40-FMB22-40 | 22 | 40 | 48 | 19 | M10 |
| BBT40-FMB27-40 | 27 | 40 | 58 | 21 | M12 |
| BBT40-FMB32-50 | 32 | 50 | 78 | 24 | M16 |
| | | | | | |
| BBT40-FMB22-60 | 22 | 60 | 48 | 19 | M10 |
| BBT40-FMB27-60 | 27 | 60 | 58 | 21 | M12 |
| BBT40-FMB32-60 | 32 | 60 | 78 | 24 | M16 |
| | | | | | |
| BBT40-FMB16-100 | 16 | 100 | 38 | 17 | M8 |
| BBT40-FMB22-100 | 22 | 100 | 48 | 19 | M10 |
| BBT40-FMB27-100 | 27 | 100 | 58 | 21 | M12 |
| BBT40-FMB32-100 | 32 | 100 | 78 | 24 | M16 |
| | | | | | |
| BBT50-FMB16-40 | 16 | 40 | 38 | 17 | M8 |
| BBT50-FMB22-40 | 22 | 40 | 48 | 19 | M10 |
| BBT50-FMB27-40 | 27 | 40 | 58 | 21 | M12 |
| BBT50-FMB32-50 | 32 | 50 | 78 | 24 | M16 |
| | | | | | |
| BBT50-FMB22-60 | 22 | 60 | 48 | 19 | M10 |
| BBT50-FMB27-60 | 27 | 60 | 58 | 21 | M12 |
| BBT50-FMB32-60 | 32 | 60 | 78 | 24 | M16 |
| | | | | | |
| BBT50-FMB16-100 | 16 | 100 | 38 | 17 | M8 |
| BBT50-FMB22-100 | 22 | 100 | 48 | 19 | M10 |
| BBT50-FMB27-100 | 27 | 100 | 58 | 21 | M12 |
| BBT50-FMB32-100 | 32 | 100 | 78 | 24 | M16 |
| | | | | | |
| BBT50-FMB22-160 | 22 | 160 | 48 | 19 | M10 |
| BBT50-FMB27-160 | 27 | 160 | 58 | 21 | M12 |
| BBT50-FMB32-160 | 32 | 160 | 78 | 24 | M16 |

Face mill holder is with retaining screw (image 2) except China, it is with universal screw (image 1) in China.
中国市场面铣刀柄标配圆头螺钉 (图 1), 其他国家标配十字花螺钉 (图 2).

Face Mill Holder
面铣刀柄

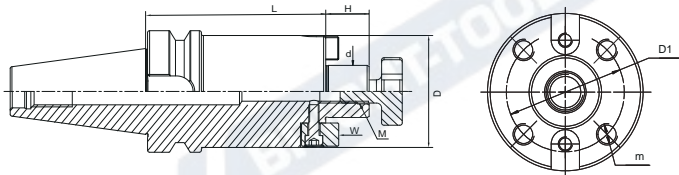
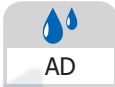
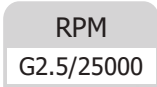
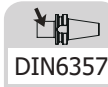



| Size | d | L | D | D1 | H | M | m |
|-----------------|----|-----|----|------|----|-----|-----|
| BBT40-FMB40-50 | 40 | 50 | 88 | 66.7 | 27 | M20 | M12 |
| BBT40-FMB40-100 | 40 | 100 | 88 | 66.7 | 27 | M20 | M12 |
| BBT50-FMB40-50 | 40 | 50 | 88 | 66.7 | 27 | M20 | M12 |
| BBT50-FMB40-100 | 40 | 100 | 88 | 66.7 | 27 | M20 | M12 |

FMB40 tool holder is with one retaining screw (image 2) . but it is with one universal screw (image 1) in China.

FMB40 刀柄中国市场面铣刀柄标配圆头螺钉 (图 1)，其他国家标配十字花螺钉 (图 2).

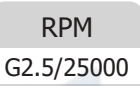
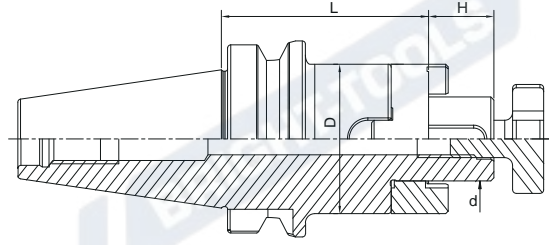

Combi Shell Mill Holder 混合插入式铣刀柄





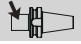

| Size | d | D | H | L |
|------------------|----|----|----|-----|
| BBT40-SEMC16-55 | 16 | 32 | 17 | 55 |
| BBT40-SEMC22-55 | 22 | 40 | 19 | 55 |
| BBT40-SEMC27-55 | 27 | 48 | 21 | 55 |
| BBT40-SEMC32-60 | 32 | 58 | 24 | 60 |
| BBT40-SEMC40-60 | 40 | 70 | 27 | 60 |
| BBT40-SEMC16-100 | 16 | 32 | 17 | 100 |
| BBT40-SEMC22-100 | 22 | 40 | 19 | 100 |
| BBT40-SEMC27-100 | 27 | 48 | 21 | 100 |
| BBT40-SEMC32-100 | 32 | 58 | 24 | 100 |
| BBT40-SEMC40-100 | 40 | 70 | 27 | 100 |
| BBT40-SEMC16-160 | 16 | 32 | 17 | 160 |
| BBT40-SEMC22-160 | 22 | 40 | 19 | 160 |
| BBT40-SEMC27-160 | 27 | 48 | 21 | 160 |
| BBT40-SEMC32-160 | 32 | 58 | 24 | 160 |
| BBT40-SEMC40-160 | 40 | 70 | 27 | 160 |
| BBT50-SEMC16-70 | 16 | 32 | 17 | 70 |
| BBT50-SEMC22-70 | 22 | 40 | 19 | 70 |
| BBT50-SEMC27-70 | 27 | 48 | 21 | 70 |
| BBT50-SEMC32-70 | 32 | 58 | 24 | 70 |
| BBT50-SEMC40-70 | 40 | 70 | 27 | 70 |
| BBT50-SEMC16-100 | 16 | 32 | 17 | 100 |
| BBT50-SEMC22-100 | 22 | 40 | 19 | 100 |
| BBT50-SEMC27-100 | 27 | 48 | 21 | 100 |
| BBT50-SEMC32-100 | 32 | 58 | 24 | 100 |
| BBT50-SEMC40-100 | 40 | 70 | 27 | 100 |
| BBT50-SEMC16-160 | 16 | 32 | 17 | 160 |
| BBT50-SEMC22-160 | 22 | 40 | 19 | 160 |
| BBT50-SEMC27-160 | 27 | 48 | 21 | 160 |
| BBT50-SEMC32-160 | 32 | 58 | 24 | 160 |
| BBT50-SEMC40-160 | 40 | 70 | 27 | 160 |

End Mill Holder Weldon
侧固刀柄

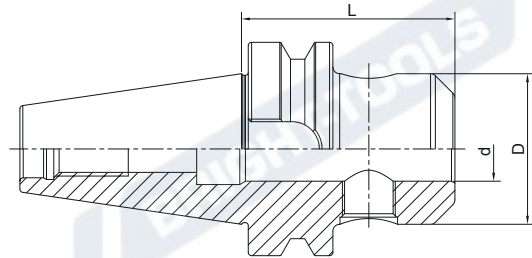

| | | | |
|--|---|--|---|
|  DIN6359/1835B |  A \nearrow ≤ 0.005 |  RPM G2.5/25000 |  AD |
|--|---|--|---|



| Size | d | D | L | M | Screw Quantity |
|-----------------|----|----|-----|-------|----------------|
| BBT40-SLA06-50 | 6 | 25 | 50 | M6 | 1 |
| BBT40-SLA08-50 | 8 | 28 | 50 | M8 | 1 |
| BBT40-SLA10-63 | 10 | 35 | 63 | M10 | 1 |
| BBT40-SLA12-63 | 12 | 42 | 63 | M12 | 1 |
| BBT40-SLA14-63 | 14 | 44 | 63 | M12 | 1 |
| BBT40-SLA16-63 | 16 | 48 | 63 | M14 | 1 |
| BBT40-SLA18-63 | 18 | 50 | 63 | M14 | 1 |
| BBT40-SLA20-63 | 20 | 52 | 63 | M16 | 1 |
| BBT40-SLA25-90 | 25 | 65 | 90 | M18*2 | 2 |
| BBT40-SLA32-100 | 32 | 72 | 100 | M20*2 | 2 |
| BBT40-SLA40-120 | 40 | 80 | 120 | M20*2 | 2 |
| | | | | | |
| BBT40-SLA06-100 | 6 | 25 | 100 | M6 | 1 |
| BBT40-SLA08-100 | 8 | 28 | 100 | M8 | 1 |
| BBT40-SLA10-100 | 10 | 35 | 100 | M10 | 1 |
| BBT40-SLA12-100 | 12 | 42 | 100 | M12 | 1 |
| BBT40-SLA14-100 | 14 | 44 | 100 | M12 | 1 |
| BBT40-SLA16-100 | 16 | 48 | 100 | M14 | 1 |
| BBT40-SLA18-100 | 18 | 50 | 100 | M14 | 1 |
| BBT40-SLA20-100 | 20 | 52 | 100 | M16 | 1 |
| | | | | | |
| BBT50-SLA06-63 | 6 | 25 | 63 | M6 | 1 |
| BBT50-SLA08-63 | 8 | 28 | 63 | M8 | 1 |
| BBT50-SLA10-63 | 10 | 35 | 63 | M10 | 1 |
| BBT50-SLA12-80 | 12 | 42 | 80 | M12 | 1 |
| BBT50-SLA14-80 | 14 | 44 | 80 | M12 | 1 |
| BBT50-SLA16-80 | 16 | 48 | 80 | M14 | 1 |
| BBT50-SLA18-80 | 18 | 50 | 80 | M14 | 1 |
| BBT50-SLA20-80 | 20 | 52 | 80 | M16 | 1 |
| BBT50-SLA25-100 | 25 | 65 | 100 | M18*2 | 2 |
| BBT50-SLA32-105 | 32 | 72 | 105 | M20*2 | 2 |
| BBT50-SLA40-110 | 40 | 80 | 110 | M20*2 | 2 |
| BBT50-SLA50-125 | 50 | 98 | 125 | M24*2 | 2 |

Morse Taper Adapter with Tang 带扁尾莫氏刀柄

DIN6383

A ≤ 0.005

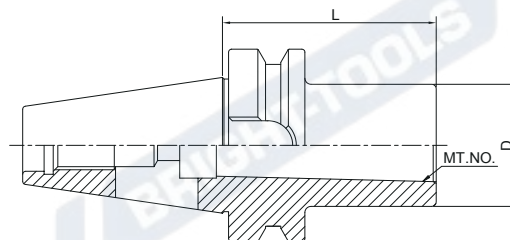
RPM
G2.5/25000

| Size | MT.NO. | D | L |
|---------------|--------|----|----|
| BBT40-MTA1-50 | 1 | 25 | 50 |
| BBT40-MTA2-50 | 2 | 32 | 50 |
| BBT40-MTA3-70 | 3 | 40 | 70 |
| BBT40-MTA4-95 | 4 | 48 | 95 |
| | | | |
| BBT50-MTA1-45 | 1 | 25 | 45 |
| BBT50-MTA2-60 | 2 | 32 | 60 |
| BBT50-MTA3-65 | 3 | 40 | 65 |
| BBT50-MTA4-95 | 4 | 48 | 95 |

Tool Holder Adapter Sleeve 转换刀柄

A ≤ 0.005

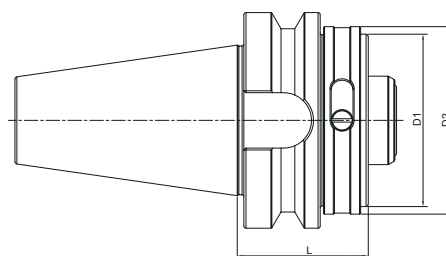
AD

| Size | D1 | D2 | L |
|------------------|-----|-----|----|
| BBT40-HSK63C-70 | 63 | 70 | 70 |
| BBT50-HSK63C-60 | 63 | 70 | 60 |
| BBT50-HSK100C-90 | 100 | 110 | 90 |

Precision Drill Chuck Holder 精密钻夹头刀柄

| | | |
|--------------|-------------------|----|
| A ↗ ≤0.03 | RPM G2.5/25000 | AD |
|--------------|-------------------|----|

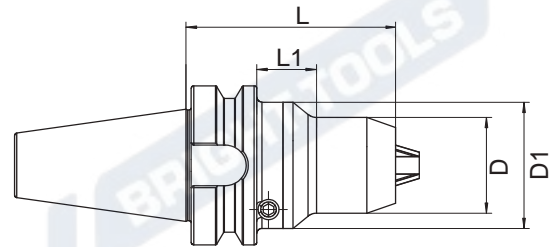

| Size | D | D1 | L | L1 | Capacity |
|-----------------|----|----|-----|----|----------|
| BBT40-CPU10-80 | 38 | 50 | 80 | 21 | 1-10 |
| BBT40-CPU13-90 | 50 | - | 90 | - | 1-13 |
| BBT40-CPU16-90 | 50 | - | 90 | - | 1-16 |
| BBT50-CPU13-100 | 50 | - | 100 | - | 1-13 |
| BBT50-CPU16-100 | 50 | - | 100 | - | 1-16 |

Runout Adjustable Flange Adapter 可调节精度法兰刀柄

| | | |
|---------------|-------------------|----|
| A ↗ ≤0.002 | RPM G2.5/25000 | AD |
|---------------|-------------------|----|

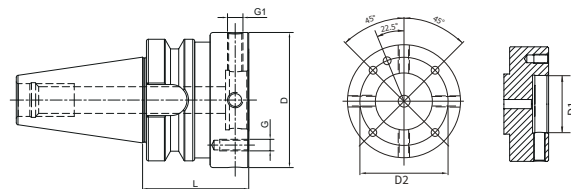

| Size | D | D1 | D2 | L | G | G1 |
|------------------|-----|----|-----|----|-----|-------|
| BBT40-MOD060-050 | 60 | 30 | 44 | 50 | M5 | M8x1 |
| BBT40-MOD070-050 | 70 | 35 | 53 | 50 | M6 | M8x1 |
| BBT40-MOD080-050 | 80 | 40 | 63 | 50 | M6 | M8x1 |
| BBT40-MOD100-070 | 100 | 50 | 79 | 70 | M8 | M10x1 |
| BBT50-MOD060-070 | 60 | 30 | 44 | 70 | M5 | M8x1 |
| BBT50-MOD070-070 | 70 | 35 | 53 | 70 | M6 | M8x1 |
| BBT50-MOD080-070 | 80 | 40 | 63 | 70 | M6 | M8x1 |
| BBT50-MOD100-070 | 100 | 50 | 79 | 70 | M8 | M10x1 |
| BBT50-MOD117-080 | 117 | 60 | 96 | 80 | M8 | M10x1 |
| BBT50-MOD140-080 | 140 | 80 | 119 | 80 | M10 | M10x1 |

Test Arbor
 主轴检测棒

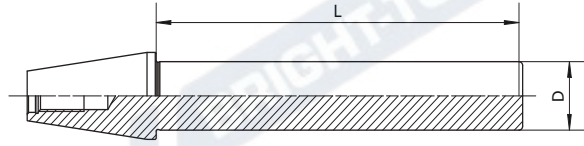
 A ↗
 ≤0.002

| Size | D | L |
|--------------|----|-----|
| BBT30-32-300 | 32 | 300 |
| BBT40-40-300 | 40 | 300 |
| BBT50-50-300 | 50 | 300 |

BRIGHT-TOOLS

BRIGHT-TOOLS

TOOL HOLDERS **NBT**

BRIGHT-TOOLS

BRIGHT-TOOLS

BRIGHT-TOOLS

BRIGHT-TOOLS

NBT Taper Standard

NBT 锥柄标准

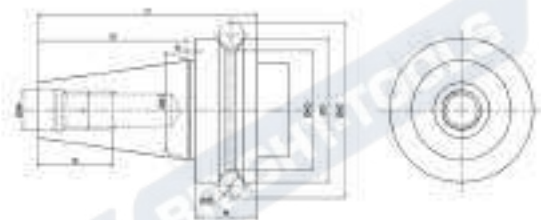

| Size | D | d1 | d2 | d3 | d4 | d5 | d6 | l1 | l2 | l3 | l4 | a | T |
|-------|-----|-------|---------|----|------|------|----|-------|-------|----|----|---|----------|
| NBT30 | 46 | 31.75 | 56.144 | 38 | 12.5 | 16.1 | 8 | 70.4 | 48.4 | 24 | 20 | 2 | M12×1.75 |
| NBT40 | 63 | 44.45 | 75.679 | 53 | 17 | 16.1 | 10 | 92.4 | 65.4 | 30 | 25 | 2 | M16×2.0 |
| NBT50 | 100 | 69.85 | 119.019 | 85 | 25 | 25.7 | 15 | 139.8 | 101.8 | 45 | 35 | 3 | M24×3.0 |

Material: Alloyed case hardened steel
Surface Treatment: Blackening and Bright
Taper tolerance: <AT3
Hardness: HRC 56-60
Carbon depth: 0.8±0.2mm
Surface Roughness: Ra<0.2µm
Balancing: G2.5/25000
Cooling: AD

ER Collet Chuck
ER 弹簧夹头刀柄

| | | | |
|---------|----------------|-------------------|----|
| DIN6499 | A ≤ 0.003 | RPM G2.5/25000 | AD |
|---------|----------------|-------------------|----|

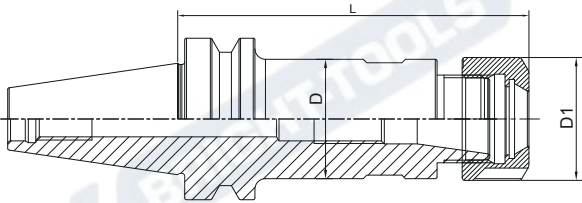

| Size | D | D1 | L | Capacity |
|---------------|----|----|----|----------|
| NBT30-ER25-70 | 42 | 42 | 70 | 2-16 |
| NBT30-ER32-70 | 50 | 50 | 70 | 2-20 |
| NBT40-ER25-70 | 42 | 42 | 70 | 2-16 |
| NBT40-ER32-70 | 50 | 50 | 70 | 2-20 |

NBT

ER Collet Chuck
ER 弹簧夹头刀柄

| | | | |
|---------|----------------|-------------------|----|
| DIN6499 | A ≤ 0.003 | RPM G2.5/25000 | AD |
|---------|----------------|-------------------|----|

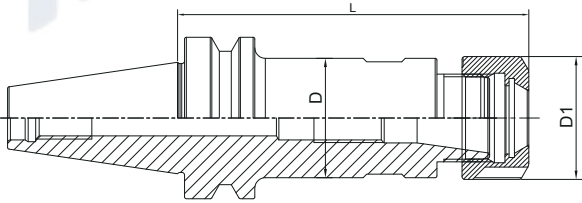

| Size | D | D1 | L | Capacity |
|---------------|----|----|----|----------|
| NBT30-ER16-60 | 28 | 28 | 60 | 1-10 |
| NBT30-ER20-60 | 34 | 34 | 60 | 1-13 |
| NBT40-ER16-70 | 28 | 28 | 70 | 1-10 |
| NBT40-ER20-70 | 34 | 34 | 70 | 1-13 |

High Speed SKS Collet Chuck

SKS 高速筒夹刀柄

| | | |
|---------------|-------------------|----|
| A ↗ ≤0.003 | RPM G2.5/25000 | AD |
|---------------|-------------------|----|

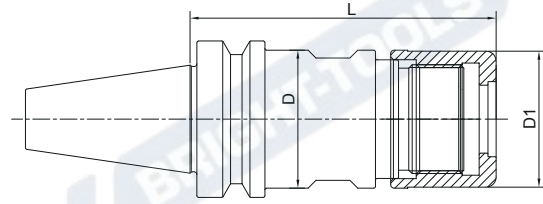

| Size | D | D1 | L | Capacity | M |
|----------------|------|------|----|----------|-----------|
| NBT30-SKS10-60 | 27.5 | 27.1 | 60 | 3-10 | M21.5*1.0 |
| NBT30-SKS16-60 | 40.6 | 40 | 60 | 4-16 | M32*1.5 |